



ISO 9001
Quality
AFNOR CERTIFICATION

precision vise, dividing head, shank boring knife, Chuck ... and soon, for CNC Machining Center, lathes, grinders, milling machines, machinery parts

UT-TECH PRECISION INDUSTRIAL CO., LTD.

UT-TECH

Precision Machine Tools Production

www.ut-tech.com.tw



UNIVERSAL
POWER VISE
MPPV

COMPANY INTRODUCTION

UT-TECH PRECISION INDUSTRIAL CO., LTD was established in 1981 and has been established for more than 40 years. It is mainly engaged in the production of various precision vises and mechanical accessories. The production plants are located in Taichung City , Taiwan.

Our company is committed to producing high-precision and high-quality products, and continues to invest in product development and innovation. We own ISO certification and numbers of product patents and move towards to an international professional precision vise manufacturer. We care about customer service and product maintenance. , we believe that we can become the best partner for customers in various machining work.

UT-TECH products have been sold in more than 40 countries. The Logo of global mark represents the concept of UT-TECH industrial product marketing in the world, and expects to become an excellent and professional company in the future.



WELCOME TO
UT-TECH PRECISION INDUSTRIAL CO., LTD.

CONTENTS

- P. 01-02** COMPANY INTRODUCTION & CONTENTS
- P. 03-04** PNEUMATIC VISE SERIES
- P. 05-10** 5-AXIS VISE SERIES
- P. 11** ZERO POINT CLAMPING SYSTEM
- P. 12-15** MC POWER MACHINE VISE SERIES
- P. 16-19** CNC POWER MACHINE VISE SERIES
- P. 20** DOUBLE MACHINE VISE
- P. 21** SEPARATE PRECISION MACHINE VISE
- P. 22** QUICK PRECISION VISE AND VISE IN TOW
- P. 23-24** PRECISION TRADITIONAL HYDRAULIC MACHINE VISE SERIES
- P. 25-26** PRECISION ANGLE LOCK VISE
- P. 27-28** PRECISION TRADITION VISE AND TEO WAY 、THREE WAY VISE
- P. 29** HIGH QUALITY CLAMP-UNIT &
PRECISION MACHINE VISE SPECIAL APPLICATION JAW PLATES
- P. 30** PRECISION MACHINE VISE SPECIAL APPLICATION JAW PLATES



MC PRECISION SUPER HI-PRESSURE RAPID VISE (TPV-SERIES)

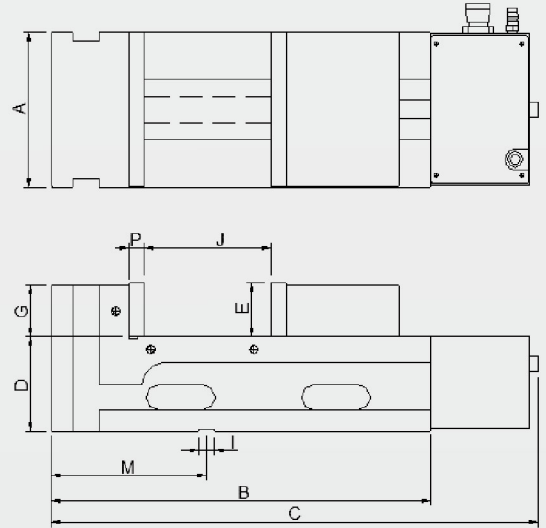

Features

- ▶ **Quick clamping and relieving**
The vise principle is the use reciprocating air compressor motor. The method of oil passage by pushing continuous pressure to achieve automation.
- ▶ **High clamping force**
Low-pressure compressed air source 8kg / cm², the clamping force can be up to ultrahigh 9000 kgf.
- ▶ **Automatically find the highest pneumatic source**
When copper and aluminum products are light processing or raw material of cast iron is heavy cutting. Set at the desired pressure with the regulator, will not result in low air pressure source and loss of pressure, and the regulator can fill and fix the pressure function automatically, to ensure the clamp of the workpiece.
- ▶ **Humanized design**
Just a manual switch control vise switch, the switching speed of just 1.5 seconds, holding a safe distance for 8mm, during operation to prevent injured. When the clamp can also be done with a special automated unmanned production system design (can be used with electrically controlled valve or via the controller machine's operation).
- ▶ **Stand, side, lying with three for use**
Vises fix sizes, body's six-sides polished plate and set aside slots, no fixture plate, you can vertical processing.
- ▶ **Ultra Material**
Vise body material with high ductility of spherical graphite cast iron (FCD600) integral product design, vise both sides of the slide hardened heat (HRC45°), ensure high precision and high wear resistance, high tensile strength.
- ▶ **Hemi-spherical structure**
The semi-sphere shape can be generated under the power of the lock, the jaw plate doesn't lift and the workpiece doesn't tilt.

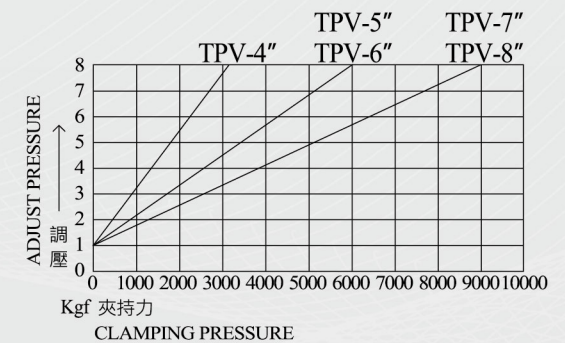
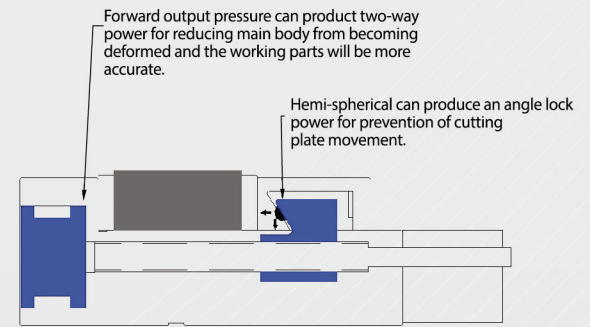

Standard Accessories

- Handle x 1 pc
- Guide key x 2 pcs
- Screw M6x10L x 2 pcs
- Vise locked block x 4 pcs

MODEL	A	B	C	D	E	G	I	M	P	J	Clamping Force kgf	G.W. KG
TPV-4"-100	100	320	435	100	48	45	16	145	15	100	3200	29
TPV-5"-150	130	380	505	105	55	52	18	145	15	150	6000	40
TPV-6"-160	160	400	525	105	58	55	18	145	15	160	6000	50
TPV-6"-250	160	490	615	105	58	55	18	145	15	250	6000	55
TPV-7"-200	180	460	585	110	63	60	18	180	18	200	9000	72
TPV-8"-200	200	470	595	110	63	60	18	180	18	200	9000	80
TPV-8"-300	200	570	695	110	63	60	18	180	18	300	9000	90

MC SUPER HI-PRESSURE DOUBLE VISE (DPV-6-100)

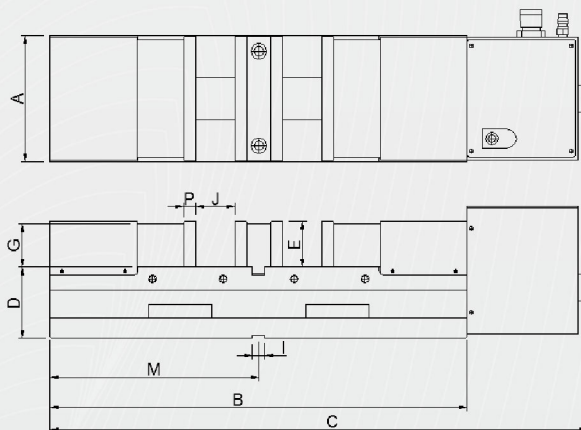
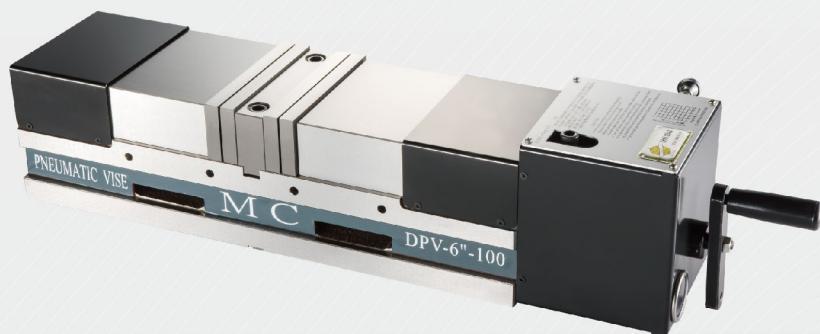

Features

▶ **Double clamping structure**

Clamping two workpieces simultaneously, increasing productivity, so that the original function of holding more rapid upgrade.

▶ **Quick clamping and relieving**

The vise principle is the use of reciprocating air compressor motor. The method of oil passage by pushing continuous pressure to achieve automation.

▶ **High clamping force**

Low-pressure compressed air source 8kg / cm², the clamping force can be up to ultra-high 4000 kgf.

▶ **Automatically find the highest pneumatic source**

When copper and aluminum products are light processing or raw material of cast iron is heavy cutting. Set at the desired pressure with the regulator, will not result in low air pressure source and loss of pressure, and the regulator can fill and fix the pressure function automatically, to ensure the clamp of the workpiece.

▶ **Humanized design**

Just a manual switch control vise switch, the switching speed of just 1.5 seconds, holding a safe distance for 5mm. During operation to prevent injured. When the clamp can also be done with a special automated unmanned production system design (can be used with electrically controlled valve or via the controller machine's operation).

▶ **Ultra Material**

Vise body material is high ductility of spherical graphite cast iron (FCD600), vise both sides of the slide hardened heat (HRC45 °), ensure high precision and high wear resistance, high tensile strength.

▶ **Hemi-spherical structure**

The semi-sphere shape can be generated under the power of the lock, the jaw plate doesn't lift and the workpiece doesn't tilt.

Hemi-spherical can produce an angle lock power for prevention of cutting plate movement.

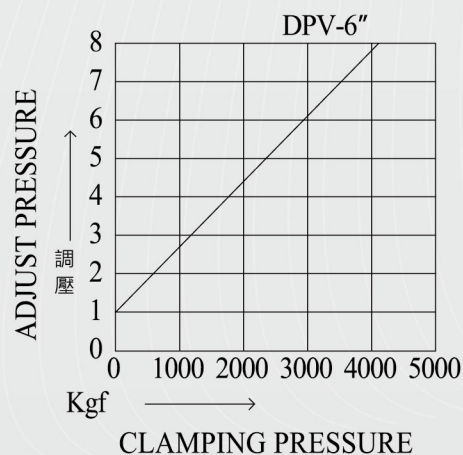
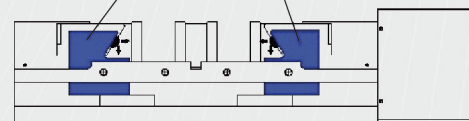

Standard Accessories

- Handle x 1 pc
- Guide key x 2 pcs
- Screw M6x10L x 2 pcs
- Vise locked block x 4 pcs

MODEL	A	B	C	D	E	G	I	M	P	J	Clamping Force	G.W. KG
DPV-6"-100	160	530	680	90	58	55	18	265	15	100	4000kgf	66

PNEUMATIC 5-AXIS VISE (PSC-100)

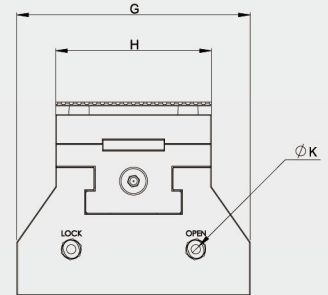
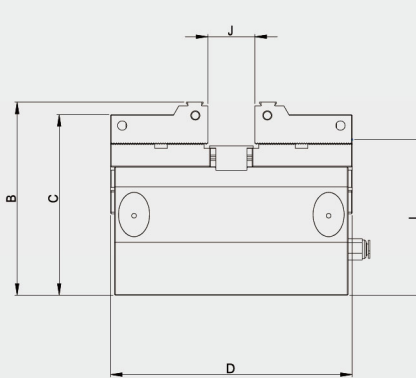
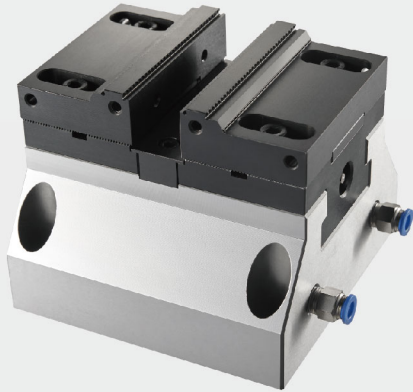

Optional Accessories

(1) ELEVATOR BASE-HUB



(2) ELEVATOR BASE -HVB

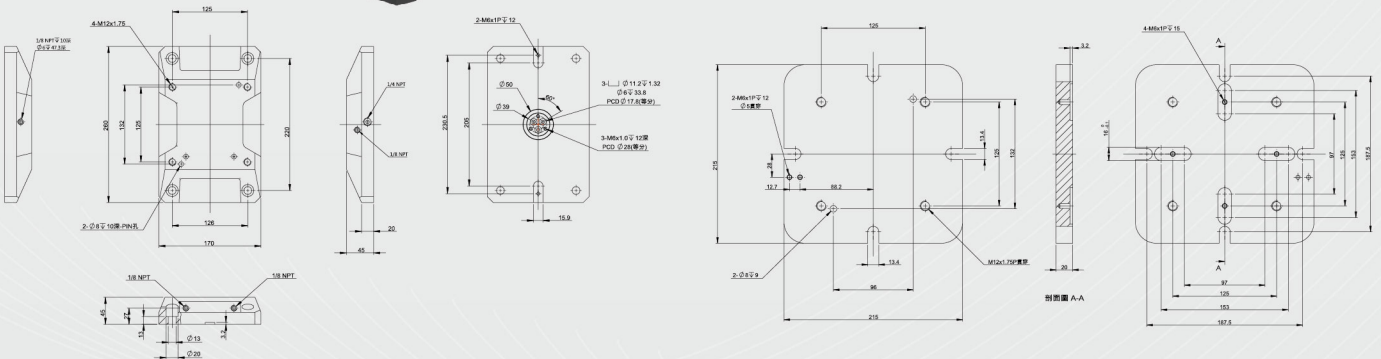
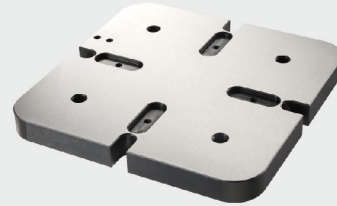

Features

- ▶ Pneumatic centering vise with high repeated clamping and positioning accuracy (up to 0.01mm), suitable for precision machining of 4-axis & 5-axis CNC machine tools & indexing spacer or precision horizontal and vertical multi-milling and cutting machining centers use.
- ▶ The vise body materials and parts are made by high alloy steel. It is adjusted and hardened heat by high quality procedures. It has high strength & high wear-resistance & high anti-tension features. The accuracy of datum plane and clamping side is high after precision multi-machining and grinding.
- ▶ The screw rod is adjusted and processed by high frequency. It increased the strength and wear-resistance substantially for screw rod.
- ▶ The heat treatment of jaw plates is HRC45°. It can clamp hardness materials of below HRC40°.
- ▶ The design of jaw plates holes for moving block. It can change and increase the needing jaw plates fast to match the clamping demands for different machining work pieces. The clamping work pieces will be used more diverse and flexible.
- ▶ The vise can be used by locked blocks and guide keys and connected joint plates or fixed on the working table for directly use.
- ▶ The height of vise body has fixed dimension. It can be used by many quantities of vises at the same time.

unit : mm

MODEL	B	C	D	G	H	J	Open stroke	K	L	Clamping Force	N.W. KG
PSC-100	124	116	155	150	100	10~90	4	Ø8	100	1,400kgf	25
PSC-100A	111.5	103.5	155	150	100	10~90	4	Ø8	87.4	1,400kgf	23.5

5-AXIS VISE (FAV-77)

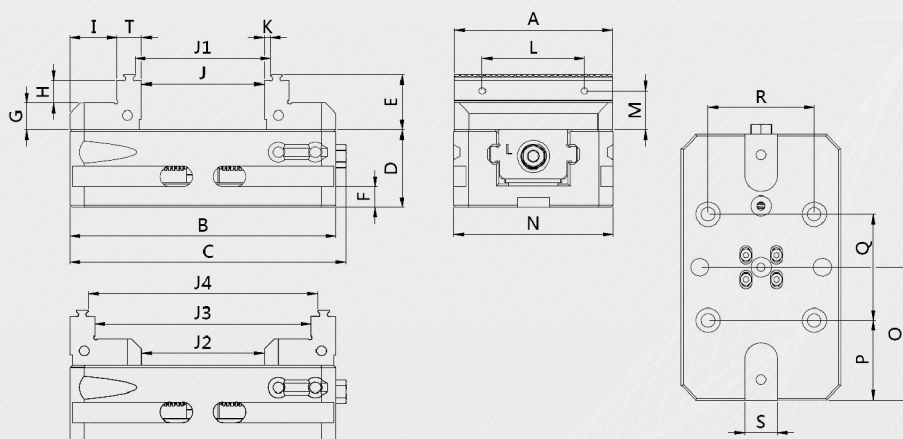

Standard Accessories

- Ratchet handle x1 pc
- Guide key x2 pcs
- Screw M6x12Lx2 pcs
- Vise locked block x4 pcs

Optional Accessories

- Pull bolt x4 pcs



Features

- ▶ The accuracy of double clamping position is high for Self centering machine vise , (reaching 0.005mm) . It is suitable for 4-axis 、 5-axis CNC machine tools 、 indexing spacer or precision horizontal and vertical multi-milling and cutting machining centers.
- ▶ The vise body materials and parts are made by high alloy steel. It is adjusted and hardened heat by high quality procedures. It has high strength 、 high wear-resistance 、 high anti-tension features. The accuracy of datum plane and clamping side is high after precision multi-machining and grinding.
- ▶ The screw rod is adjusted and processed by high frequency , then processed by precision titanium plating. It increased the strength and wear-resistance substantially.
- ▶ The heat treatment of jaw plates is HRC45°~48°. It can clamp hardness materials .
- ▶ The design of jaw plates holes for moving block. It can change and increase the needing jaw plates fast to match the clamping demands for different machining work pieces. The clamping work pieces will be used more diverse and flexible.
- ▶ The vise has five clamping ways to suit for different machining ways and work piece size. To provide flexible clamping ways.
- ▶ The vise can be used by locked blocks and guide keys and connected joint plates or fixed on the working table directly. It can save purchasing cost.
- ▶ The height of vise body has fixed dimension. (D) . It can be used by many quantities of vises at the same time.
- ▶ The special design of vise has patent.

unit : mm

MODEL	A	B	C	D	E	F	G	H
FAV-77	77	130	135	38	27	10	13	11
I	T	K	L	M	N	O	P	Q
23	12	3	135	19	78	65	39	52
R	S	J	J1	J2	J3	J4	Clamping force	N.W. KG
52	16	60	66	60	106	112	1000kgf	4kgs

5-AXIS VISE (FAV-100)

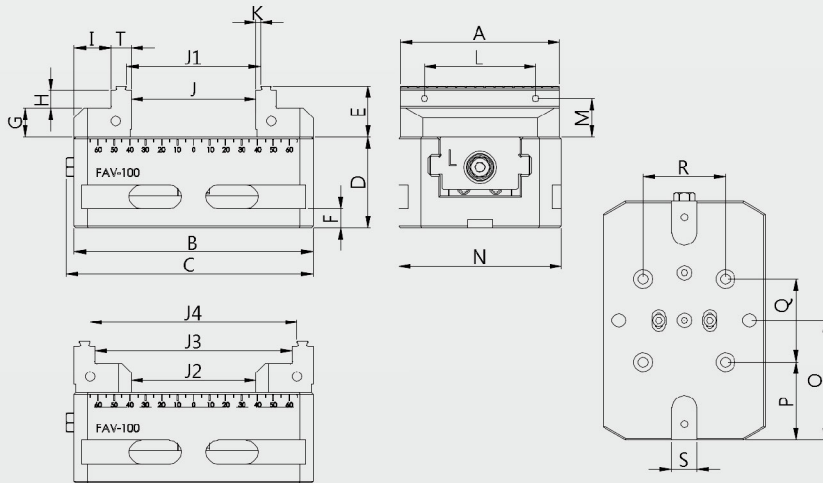
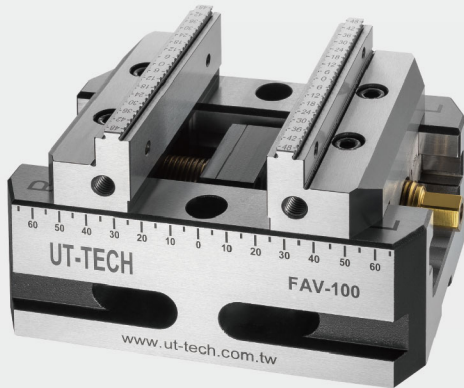

Standard Accessories

- Ratchet handle x1 pc
- Guide key x2 pcs
- Screw M6x12Lx2 pcs
- Vise locked block x4 pcs

Optional Accessories

- Pull bolt x4 pcs
- Quick point single plates x1 secs



Features

- ▶ The accuracy of double clamping position is high for Self centering machine vise , (reaching 0.01mm) , It is suitable for 4-axis 、 5-axis CNC machine tools 、 indexing spacer or precision horizontal and vertical multi-milling and cutting machining centers.
- ▶ The vise body materials and parts are made by high alloy steel. It is adjusted and hardened heat by high quality procedures. It has high strength 、 high wear-resistance 、 high anti-tension features. The accuracy of datum plane and clamping side is high after precision multi-machining and grinding.
- ▶ The screw rod is adjusted and processed by high frequency , then processed by precision titanium plating. It increased the strength and wear-resistance substantially.
- ▶ The heat treatment of jaw plates is HRC45° . It can clamp hardness materials of below HRC40° .
- ▶ The design of jaw plates holes for moving block. It can change and increase the needing jaw plates fast to match the clamping demands for different machining work pieces. The clamping work pieces will be used more diverse and flexible.
- ▶ The vise has five clamping ways to suit for different machining ways and work piece size. To provide flexible clamping ways.
- ▶ The vise can be used by locked blocks and guide keys and connected joint plates or fixed on the working table directly.
- ▶ The height of vise body has fixed dimension. (D) , It can be used by many quantities of vises at the same time.
- ▶ The special design of vise has patent.

unit : mm

MODEL	A	B	C	D	E	F	G	H	
FAV-100	100	150	155	57	32	12	18	11	
	I	T	K	L	M	N	O	Q	
	23	13	3	70	24	102	75	49	
	R	S	J	J1	J2	J3	J4	Clamping force	N.W. KG
	52	16	78	84	78	124	130	1300kgf	5.8kgs

5-AXIS SELF CENTERING MACHINE VISE (FCV-100)

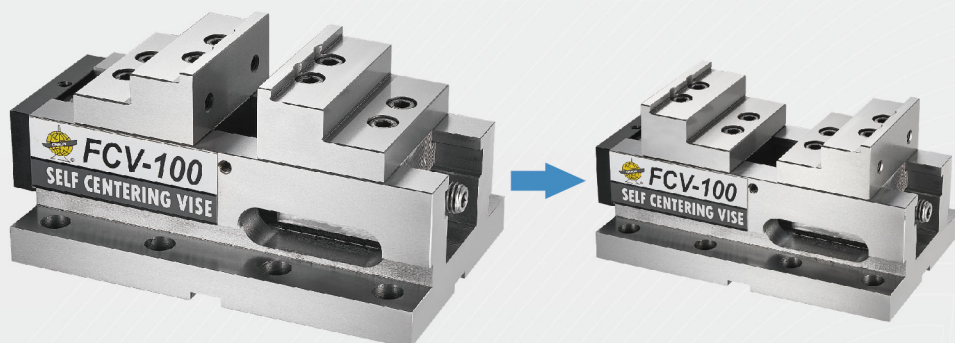

Standard Accessories

- Ratchet handle x1 pc
- Guide key x2 pcs
- Screw M6x12Lx2 pcs
- Vise locked block x4 pcs

Optional Accessories

- Pull bolt x4 pcs

Features

- ▶ Length the best suited to the use of five-axis complex cutting machine
- ▶ Vise both sides of the slide hardened heat (HRC50 °), ensure high precision and high wear resistance, high tensile strength.
- ▶ Two-way design with the center of repetition position, accurate position for processing.

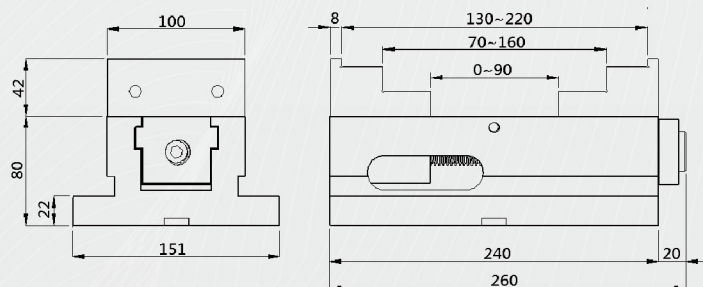

5-AXIS VISE (FAV-125)



Can installed with Pull bolts , and collocation with zero point system to use

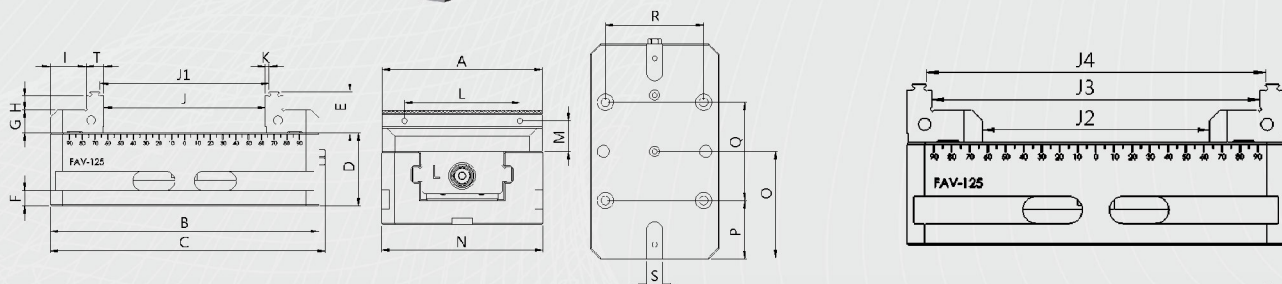

unit : mm

MODEL	A	B	C	D	E	F	G	H
FAV-125	125	210	215	57	32	12	18	11
I	T	K	L	M	N	O	P	Q
28	14	3	90	24	126	104	57	96
R	S	J	J1	J2	J3	J4	Clamping force	N.W. KG
96	16	126	132	126	182	188	1500kgf	11kgs

Standard Accessories : ■ Ratchet handle x1 pc ■ Guide key x2 pcs ■ Screw M6x12Lx2 pcs ■ Vise locked block x4 pcs
Optional Accessories : ■ Pull bolt x4 pcs ■ Quick point single plates x1 secs

MACHINE VISE SERIES

5-AXIS VISE (FAV-125-310L)

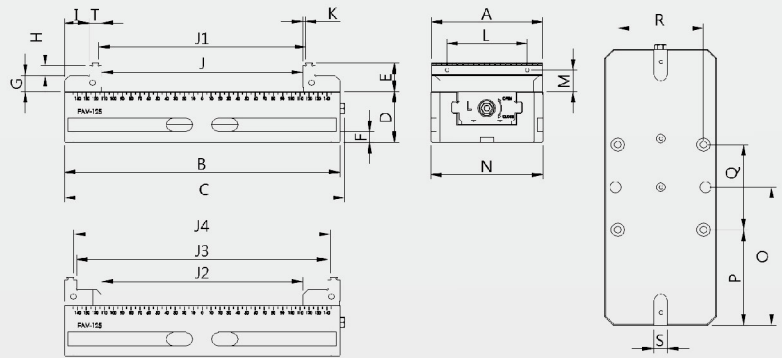
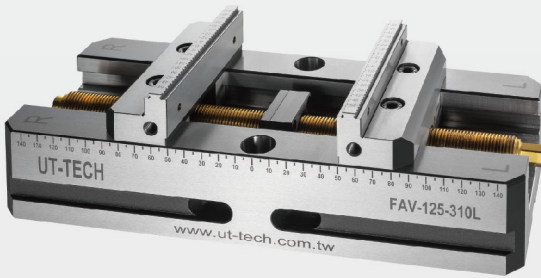

unit : mm

MODEL	A	B	C	D	E	F	G	H
FAV-125-310L	125	310	315	57	32	12	18	11
I	T	K	L	M	N	O	P	Q
28	14	3	90	24	126	155	107	96
R	S	J	J1	J2	J3	J4	Clamping force	N.W. KG
96	16	226	232	226	282	288	1800kgf	13.5kgs

Standard Accessories : ■ Ratchet handle x1 pc ■ Guide key x2 pcs ■ Screw M6x12Lx2 pcs ■ Vise locked block x4 pcs
 Optional Accessories : ■ Pull bolt x4 pcs ■ Quick point single plates x1 secs

5-AXIS VISE (DFV-125)

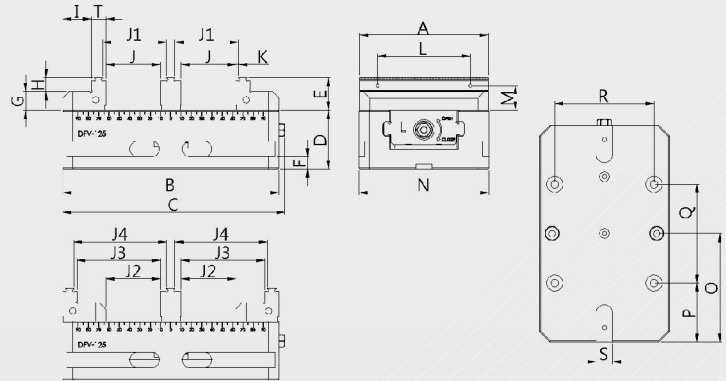
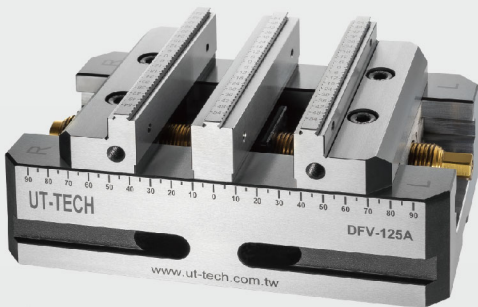

unit : mm

MODEL	A	B	C	D	E	F	G	H
DFV-125	125	210	215.5	57	32	12	18	14
I	T	K	L	M	N	O	P	Q
28	14	3	90	24	126	105	57	96
R	S	J	J1	J2	J3	J4	Clamping force	N.W. KG
96	16	53	62	53	81	90	1800kgf	10.6kgs

Standard Accessories : ■ Ratchet handle x1 pc ■ Guide key x2 pcs ■ Screw M6x12Lx2 pcs ■ Vise locked block x4 pcs
 Optional Accessories : ■ Pull bolt x4 pcs ■ Quick point single plates x1 secs

Features

- ▶ The accuracy of double clamping position is high for Self centering machine vise , (reaching 0.01mm) , It is suitable for 4-axis 、 5-axis CNC machine tools 、 indexing spacer or precision horizontal and vertical multi-milling and cutting machining centers.
- ▶ The vise body materials and parts are made by high alloy steel. It is adjusted and hardened heat by high quality procedures. It has high strength 、 high wear-resistance 、 high anti-tension features. The accuracy of datum plane and clamping side is high after precision multi-machining and grinding.
- ▶ The screw rod is adjusted and processed by high frequency , then processed by precision titanium plating. It increased the strength and wear-resistance substantially.
- ▶ The heat treatment of jaw plates is HRC45°. It can clamp hardness materials of below HRC40°.
- ▶ The design of jaw plates holes for moving block. It can change and increase the needing jaw plates fast to match the clamping demands for different machining work pieces. The clamping work pieces will be used more diverse and flexible.
- ▶ The vise has five clamping ways to suit for different machining ways and work piece size. To provide flexible clamping ways.
- ▶ The vise can be used by locked blocks and guide keys and connected joint plates or fixed on the working table directly.
- ▶ The height of vise body has fixed dimension. (D) , It can be used by many quantities of vises at the same time.
- ▶ The special design of vise has patent.

5-AXIS VISE (FAV-220/280)

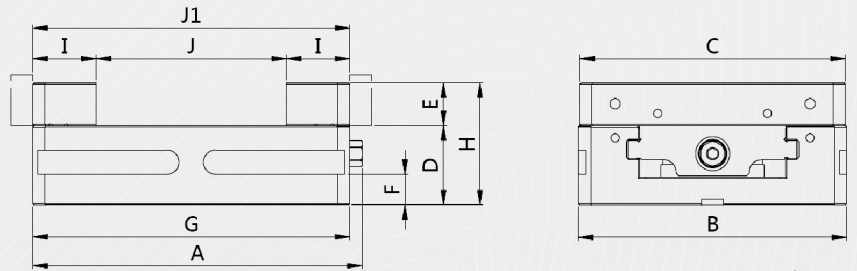

unit : mm

MODEL	A	B	C	D	E	F	G	H	I	J	J1	Clamping force	N.W. KG
FAV-220	270	220	218	65	35	25	260	100	52	156	260	2000kgf	32kgs
FAV-280	290	280	278	80	40	25	280	120	62	156	280	2500kgf	50kgs

Standard Accessories : ■ Ratchet handle x1 pc ■ Guide key x2 pcs
 ■ Screw M6x12Lx2 pcs ■ Vise locked block x4 pcs

Features

- ▶ The accuracy of double clamping position is high for Self centering machine vise , (reaching 0.015mm) , It is suitable for 4-axis 、 5-axis CNC machine tools 、 indexing spacer or precision horizontal and vertical multi-milling and cutting machining centers.
- ▶ The design of big opening jaws can clamp bigger work pieces(It should fit big work table plate to be used.)
- ▶ The vise body materials and parts are made by high alloy steel. It is adjusted and hardened heat by high quality procedures. It has high strength 、 high wear-resistance 、 high anti-tension features. The accuracy of datum plane and clamping side is high after precision multi-machining and grinding.
- ▶ The screw rod is adjusted and processed by high frequency. It increased the strength and wear-resistance substantially.
- ▶ The heat treatment of jaw plates is HRC45°. It can clamp hardness materials of below HRC40°.
- ▶ The design of jaw plates holes for moving block. It can change and increase the needing jaw plates fast to match the clamping demands for different machining work pieces. The clamping work pieces will be used more diverse and flexible.
- ▶ The vise has two clamping ways(J~J1) to suit for different machining ways and work piece size. To provide flexible clamping ways.
- ▶ The vise can be used by locked blocks and guide keys and connected joint plates or fixed on the working table directly. (It's not necessary to be used by quick mode change systems). It can save purchasing cost.
- ▶ The height of vise body has fixed dimension. (D) , It can be used by many quantities of vises at the same time.
- ▶ The special design of vise has patent.

ONE WAY STEEL VISE (FFAV-280)

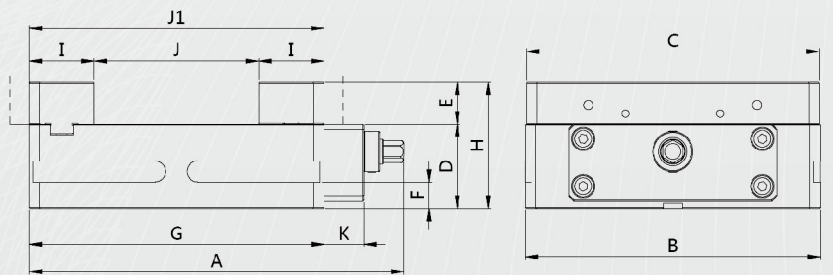
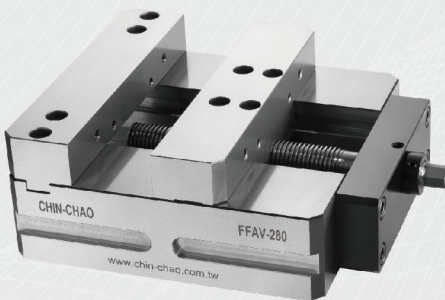

unit : mm

MODEL	A	B	C	D	E	F	G	H	I	J	J1	K	Clamping force	N.W. KG
FFAV-280	356	280	278	80	40	25	280	120	62	156	280	38	2500kgf	57kgs

P.S. : The jaw plates can be customized.

Features

- ▶ The accuracy of double clamping position is high for independent self centering vise. (reaching 0.015mm) It is suitable for 4-axis 、 5-axis CNC machine tools 、 indexing spacers or precision horizontal and vertical multi-milling and cutting machining centers.
- ▶ The screw rod is adjusted and processed by high frequency. It increased the strength and wear-resistance substantially.
- ▶ The heat treatment of jaw plates is HRC45°. It can clamp hardness materials of below HRC40°.
- ▶ The design of jaw plates holes for moving block. It can change and increase the needing jaw plates fast to match the clamping demands for different machining work pieces. The clamping work pieces will be used more diverse and flexible.
- ▶ The vise has two clamping ways(J~J1) to suit for different machining ways and work piece size. To provide flexible clamping ways.
- ▶ The height of vise body has fixed dimension. (D) It can be used by many quantities of vises at the same time.



Standard Accessories

■ Ratchet handle x1 pc ■ Guide key x2 pcs
 ■ Screw M6x12Lx2 pcs ■ Vise locked block x4 pcs

ZERO POINT CLAMPING (QPB-96A)

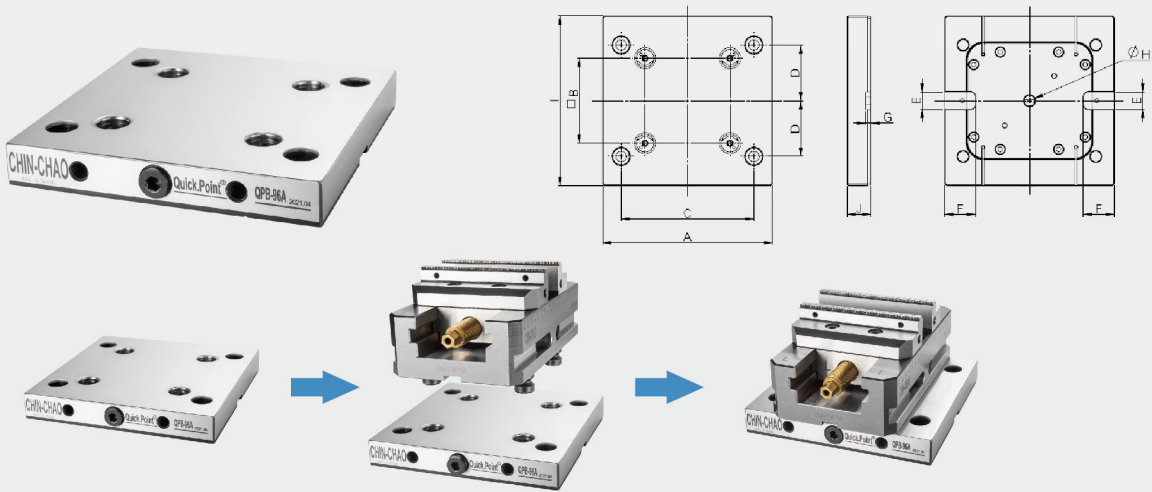

Can be combined the pull bolt with machine vise or other connecting plate for quick positioning

Features

- ▶ The hole distance of pull bolt is 96mm. The 4 pcs of pull bolts can provide 6 tons of clamping force (the 1 pc is around 1.5 tons pulling force), it suits for 63 gapes interval of T groove.
- ▶ The depth of quick change system is just 27mm (quick change system of fixtures).
- ▶ By using the clamping structure of mechanical wedge pin , it is easy to operate the lock operation of pulling down the bolt.
- ▶ Even the non-skilled person, also can operate it fast and precise. The accuracy of double clamping position is 0.01mm.
- ▶ It has application ability to support any CNC machining center machines.
(it can match 4-axis rotary table \ 5-axis rotary table \ trunnion rotary tilting table)

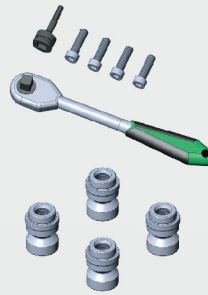

Standard Accessories

- Ratchet handle x1 pc
- Hexagon socket x1 pc
- M10x35L Screw x4 pcs

Optional Accessories

- Pull bolt x4 pcs

MODEL	A	B	C	D	E	F	G	H	I	J	Clamping force	N.W KG
QPB-96A	192	96	150	63	20	35	6	12	192	27	6000kgf	7kgs

ZERO POINT CLAMPING (QPB-96B)

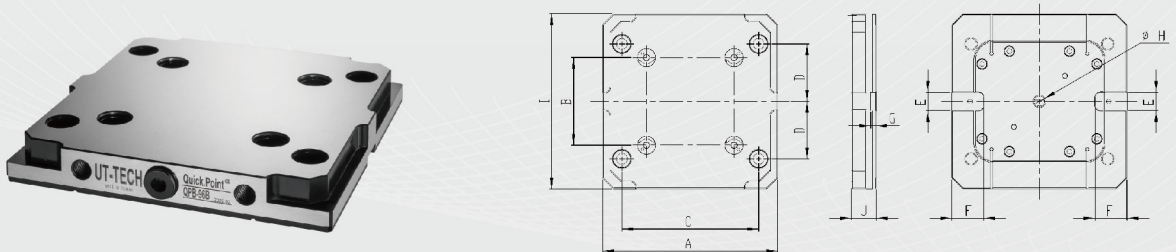

Features

- ▶ The hole distance of pull bolt is 96mm. The 4 pcs of pull bolts can provide 6 tons of clamping force (the 1 pc is around 1.5 tons pulling force), it suits for 63 gapes interval of T groove.
- ▶ The depth of quick change system is just 27mm (quick change system of fixtures).
- ▶ By using the clamping structure of mechanical wedge pin , it is easy to operate the lock operation of pulling down the bolt.
- ▶ Even the non-skilled person, also can operate it fast and precise. The accuracy of double clamping position is 0.01mm.
- ▶ It has application ability to support any CNC machining center machines.
(it can match 4-axis rotary table \ 5-axis rotary table \ trunnion rotary tilting table)

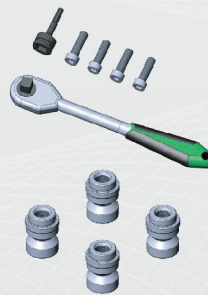

Standard Accessories

- Ratchet handle x1 pc
- Hexagon socket x1 pc
- M10x35L Screw x4 pcs

Optional Accessories

- Pull bolt x4 pcs

MODEL	A	B	C	D	E	F	G	H	I	J	CLAMPING FORCE	N.W
QPB-96B	192	96	150	63	20	35	6	12	192	27	6000kgf	6.4kgs

MC POWER MACHINE VISE -MECHANICAL TYPE



MPPV

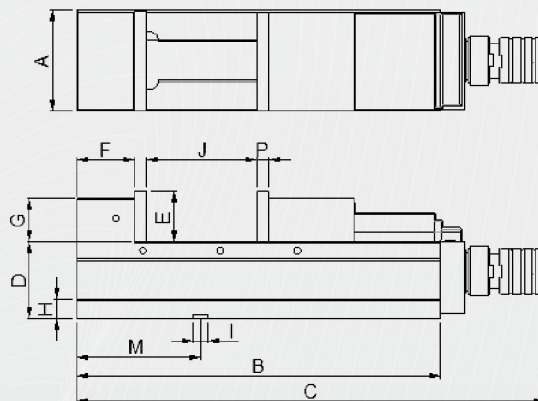

Four clamping ways for choice

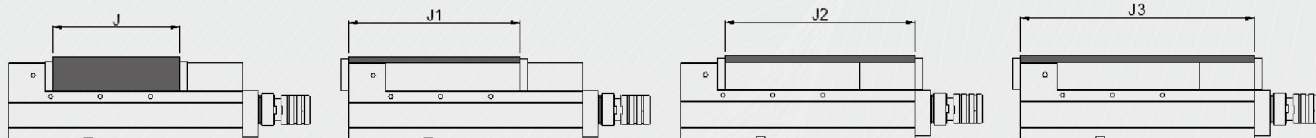

Features

- ▶ The vise is made by precision processing and grinding processes, it's suitable for vertical / horizontal machine centers to precision processing.
- ▶ Vise body material is high ductility of spherical graphite cast iron (FCD600) integral product design, vise both sides of the slide hardened heat (HRC50°), ensure high precision and high wear resistance, high tensile strength.
- ▶ Jaw hardened heat (HRC55 °).
- ▶ Angle lock semi-sphere can be generated under the power of the lock, removes the workpiece to be lifted.
- ▶ Mechanism design (patent design) with rapid pressurization and high clamping force of the unique characteristics of the pressuring mechanism (highest up to 5500 kgf).
- ▶ The vise has four clamping ways for client to choose.
- ▶ The vise with anti-litter design prevents iron filings drop into the vise, and iron filings easily discharged inside the interior and extend its lifetime.
- ▶ These vises have fixed specifications. Many vises will be used together at the same time.

Standard Accessories

- Ratchet handle x1 pc
- Adapter x1 pc
- Guide key x2 pcs
- Screw M6x12L x2 pcs
- Vise locked block x4 pcs

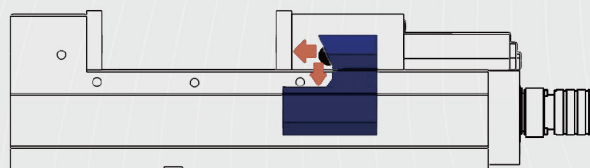

MODEL	A	B	C	D	E	F	G	H	I	M	P	J	J ₁	J ₂	J ₃	Clamping Force kgf	G.W KG
MPPV-100A	100	395	530	85	53	60	50	25	18	110	15	200	280	320	390	3500	28
MPPV-130A	130	470	605	100	58	75	55	25	18	160	15	250	340	370	460	4500	45
MPPV-160A	160	545	680	100	63	80	60	25	18	200	18	300	390	430	530	5000	64
MPPV-160S	160	488	622	100	63	80	60	25	18	200	18	250	350	390	480	5000	58
MPPV-160L	160	750	885	100	63	90	60	25	18	200	18	500	600	640	740	5000	90
MPPV-200A	200	605	740	110	63	95	60	25	18	220	18	340	460	490	600	5500	86

MC POWER MACHINE VISE -HYDRAULIC TYPE



HPPV

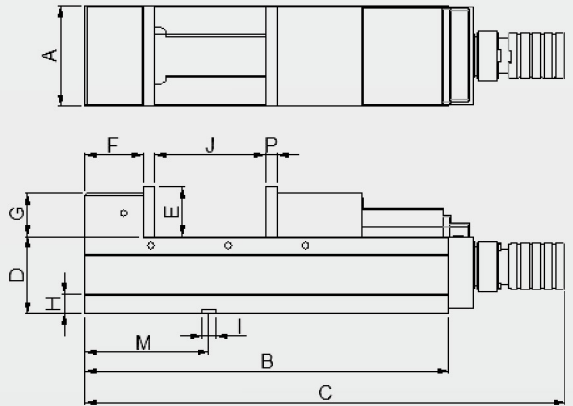

Four clamping ways for choice

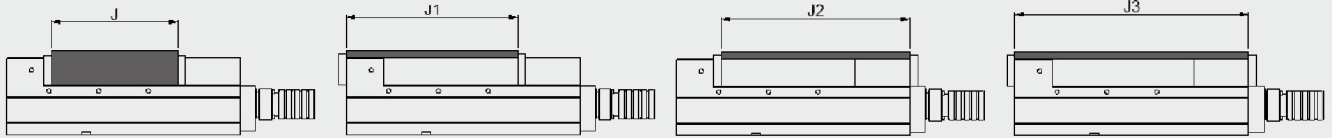

Features

- ▶ The vise is made by precision processing and grinding processes, it's suitable for vertical / horizontal machine centers to precision processing.
- ▶ Vise body material is high ductility of spherical graphite cast iron (FCD600) integral product design, vise both sides of the slide hardened heat (HRC50°), ensure high precision and high wear resistance, high tensile strength.
- ▶ Jaw hardened heat (HRC55 °).
- ▶ Angle lock semi-sphere can be generated under the power of the lock, removes the workpiece to be lifted.
- ▶ Hydraulic design (patent design) with rapid pressurization and high clamping force of the unique characteristics of the pressuring mechanism (highest up to 5500 kgf).
- ▶ The vise has four clamping ways for client to choice.
- ▶ The vise with anti-litter design prevents iron filings drop into the vise, and iron filings easily discharged inside the interior and extend its lifetime.
- ▶ These vises have fixed specifications. Many vises will be used together at the same time.

Standard Accessories

- Ratchet handle x1 pc ■ Adapter x1 pc ■ Guide key x2 pcs
- Screw M6x12L x2 pcs ■ Vise locked block x4 pcs

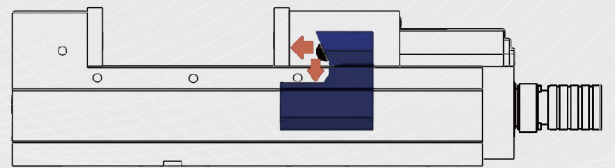

MODEL	A	B	C	D	E	F	G	H	I	M	P	J	J ₁	J ₂	J ₃	Clamping force kgf	G.W KG
HPPV-100A	100	395	552	85	53	60	50	25	18	110	15	200	280	320	390	3500	29
HPPV-130A	130	470	626	100	58	75	55	25	18	160	15	250	340	370	460	4500	46
HPPV-160A	160	545	702	100	63	80	60	25	18	200	18	300	390	430	530	5000	65
HPPV-160S	160	488	644	100	63	80	60	25	18	200	18	250	350	390	480	5000	59
HPPV-160L	160	750	910	100	63	90	60	25	18	200	18	500	600	640	740	5000	91
HPPV-200A	200	605	762	110	63	95	60	25	18	220	18	340	460	490	600	5500	87

MC POWER MACHINE VISE-ADJUSTABLE TYPE



APPV

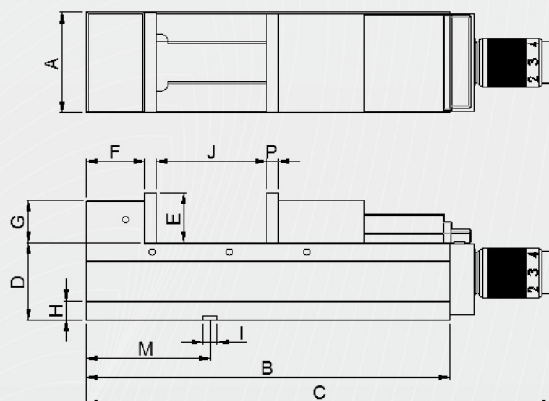

Four clamping ways for choice



Features

- ▶ The vise is made by precision processing and grinding processes, it's suitable for vertical / horizontal machine centers to precision processing.
- ▶ Vise body material is high ductility of spherical graphite cast iron (FCD600) integral product design, vise both sides of the slide hardened heat (HRC50°), ensure high precision and high wear resistance, high tensile strength.
- ▶ Jaw hardened heat (HRC55°).
- ▶ Angle lock semi-sphere can be generated under the power of the lock, removes the workpiece to be lifted.
- ▶ Mechanism design (patented design), with rapid pressurization and high clamping force of the unique characteristics of the pressuring mechanism (highest up to 5500 kgf).
- ▶ The vise has four clamping ways for client to choose.
- ▶ The vise with anti-litter design prevents iron filings drop into the vise, and iron filings easily discharged inside the interior and extend its lifetime.
- ▶ These vises have fixed specifications. Many vises will be used together at the same time.

Standard Accessories

- Ratchet handle x1 pc
- Adapter x1 pc
- Guide key x2 pcs
- Screw M6x12L x2 pcs
- Vise locked block x4 pcs

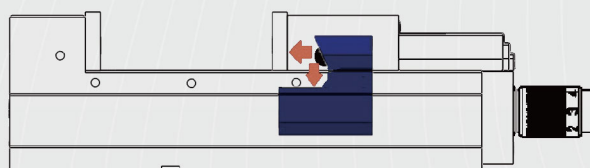

MODEL	A	B	C	D	E	F	G	H	I	M	P	J	J ₁	J ₂	J ₃	Clamping force kgf	G.W KG
APPV-100A	100	395	527	85	53	60	50	25	18	110	15	200	280	320	390	3500	28
APPV-130A	130	470	602	100	58	75	55	25	18	160	15	250	340	370	460	4500	45
APPV-160A	160	545	677	100	63	80	60	25	18	200	18	300	390	430	530	5000	64
APPV-160S	160	488	620	100	63	80	60	25	18	200	18	250	350	390	480	5000	58
APPV-160L	160	750	885	100	63	90	60	25	18	220	18	500	600	640	740	5000	91
APPV-200A	200	605	737	110	63	95	60	25	18	220	18	340	460	490	600	5500	86

MC PRECISION MACHINE VISE



MV

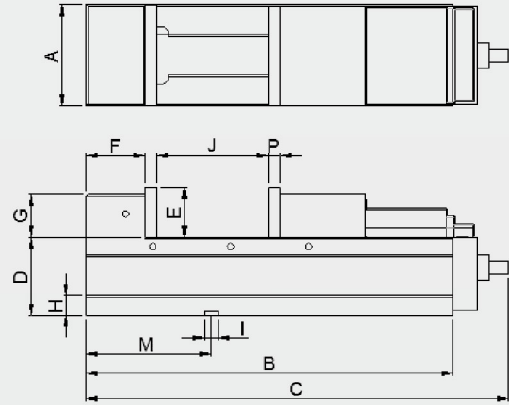

Four clamping ways for choice

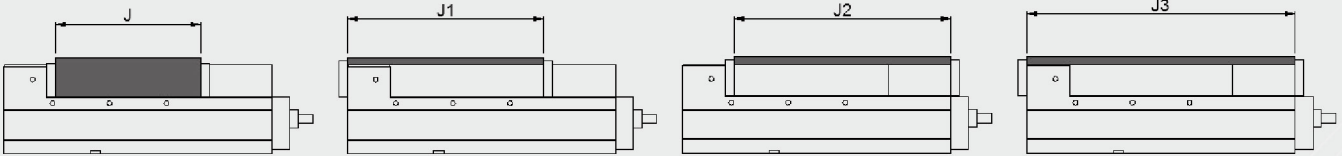

Features

- ▶ The vise is made by precision processing and grinding processes, it's suitable for vertical / horizontal machine centers to precision processing.
- ▶ Vise body material is high ductility of spherical graphite cast iron (FCD600) integral product design, vise both sides of the slide hardened heat (HRC50^o), ensure high precision and high wear resistance, high tensile strength.
- ▶ Jaw hardened heat (HRC55^o).
- ▶ Angle lock semi-sphere can be generated under the power of the lock, removes workpiece to be lifted.
- ▶ The vise has four clamping ways for client to choice.
- ▶ The vise with anti-litter design prevents iron filings drop into the vise, and iron filings easily discharged and extend its lifetime.
- ▶ These vises have fixed specifications. Many vises will be used together at the same time.

Standard Accessories

- Handle x1 pc ■ Guide key x2 pcs ■ Screw M6x12L x2 pcs
- Vise locked block x4 pcs

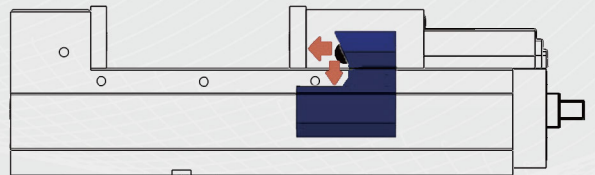
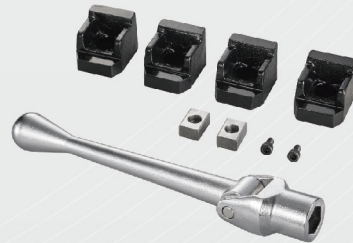

MODEL	A	B	C	D	E	F	G	H	I	M	P	J	J ₁	J ₂	J ₃	G.W. KG
MV-100A	100	395	485	85	53	60	50	25	18	110	15	200	270	310	380	26
MV-130A	130	470	560	100	58	75	55	25	18	160	15	250	330	360	450	44
MV-160A	160	545	635	100	63	80	60	25	18	200	18	300	380	420	520	63
MV-160S	160	488	580	100	63	80	60	25	18	200	18	250	340	380	470	57
MV-160L	160	750	840	100	63	90	60	25	18	250	18	500	600	640	740	90
MV-200A	200	605	695	110	63	95	60	25	18	220	18	340	460	490	600	84

CNC POWER MACHINE VISE -MECHANICAL TYPE



MFPV

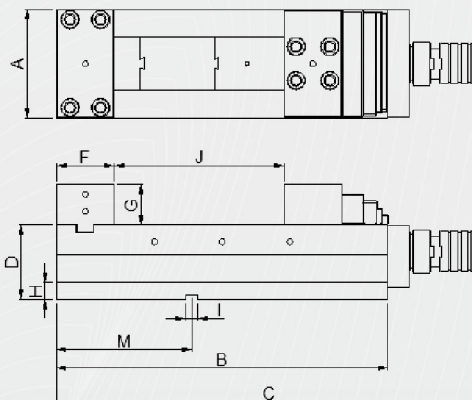

Four clamping ways for choice

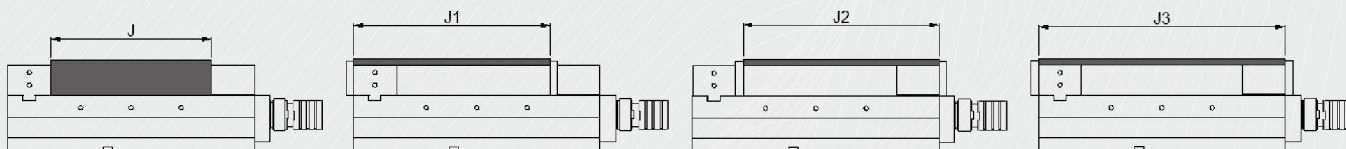

Features

- ▶ The vise is made by precision and grinding processes, it's suitable for vertical / horizontal machine centers.
- ▶ Vise body material is high ductility of spherical graphite cast iron (FCD600) integral product design, vise both sides of the slide hardened heat (HRC50°), ensure high precision and high wear resistance, high tensile strength.
- ▶ Fixed block and sliding block are steel and heat treatment HRC 50° or more, hardness and wear resistance is high, user may add or replace the processing needs of different specifications of the jaw plate.
- ▶ Mechanism design (patented design), with rapid pressurization and high clamping force of the unique characteristics of the pressuring mechanism (highest up to 5500 kgf).
- ▶ The vise have four clamping ways for client to choice.
- ▶ The vise with anti-litter design prevents iron filings drop into the vise, and iron filings easily discharged inside the interior and extend its lifetime.
- ▶ These vises have fixed specifications. Many vises will be used together at the same time.

Standard Accessories

- Ratchet handle x1 pc
- Adapter x1 pc
- Guide key x2 pcs
- Screw M6x12L x2 pcs
- Vise locked block x4 pcs



MODEL	A	B	C	D	F	G	H	I	M	J	J ₁	J ₂	J ₃	Clamping Force kgf	G.W. KG
MFPV-100	100	310	445	85	75	50	25	18	110	150	210	210	300	3500	30
MFPV-130	130	410	545	100	80	55	25	18	135	240	300	300	400	4500	45
MFPV-160	160	490	625	110	85	60	25	18	200	300	380	380	480	5000	64
MFPV-160L	160	550	685	110	85	60	25	18	200	360	440	440	540	5000	69
MFPV-200	200	530	665	110	85	60	25	18	220	350	420	420	520	5500	86

CNC POWER MACHINE VISE - HYDRAULIC TYPE



HFPV

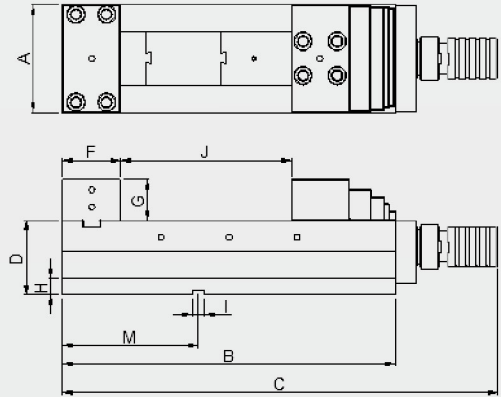

Four clamping ways for choice

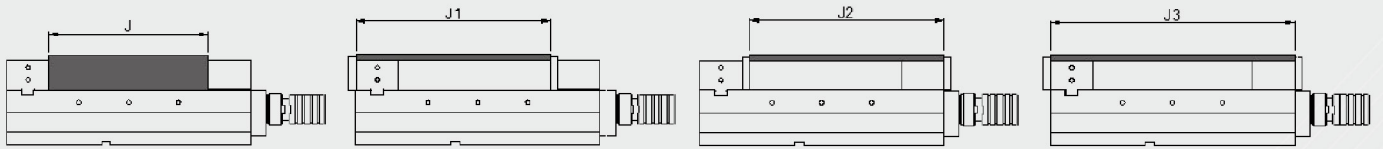

Features

- ▶ The vise is made by precision and grinding processes, it's suitable for vertical / horizontal machine centers.
- ▶ Vise body material is high ductility of spherical graphite cast iron (FCD600) integral product design, vise both sides of the slide hardened heat (HRC50°), ensure high precision and high wear resistance, high tensile strength.
- ▶ Fixed block and sliding block are steel and heat treatment HRC 50° or more, hardness and wear resistance is high, user may add or replace the processing needs of different specifications of the jaw plate.
- ▶ Mechanism design (patented design), with rapid pressurization and high clamping force of the unique characteristics of the pressuring mechanism (highest up to 5500 kgf).
- ▶ The vise have four clamping ways for client to choice.
- ▶ The vise with anti-litter design prevents iron filings drop into the vise, and iron filings easily discharged inside the interior and extend its lifetime.
- ▶ These vises have fixed specifications. Many vises will be used together at the same time.

Standard Accessories

- Ratchet handle x1 pc ■ Adapter x1 pc ■ Guide key x2 pcs
- Screw M6x12L x2 pcs ■ Vise locked block x4 pcs



MODEL	A	B	C	D	F	G	H	I	M	J	J ₁	J ₂	J ₃	Clamping Force kgf	G.W. KG
HFPV-100	100	310	466	85	75	50	25	18	110	150	210	210	300	3500	30
HFPV-130	130	410	566	100	80	55	25	18	135	240	300	300	400	4500	45
HFPV-160	160	490	646	110	85	60	25	18	200	300	380	380	480	5000	65
HFPV-160L	160	550	706	110	85	60	25	18	200	360	440	440	540	5000	69
HFPV-200	200	530	686	110	85	60	25	18	220	350	420	420	520	5500	87

CNC POWER MACHINE VISE -ADJUSTABLE TYPE



AFPV

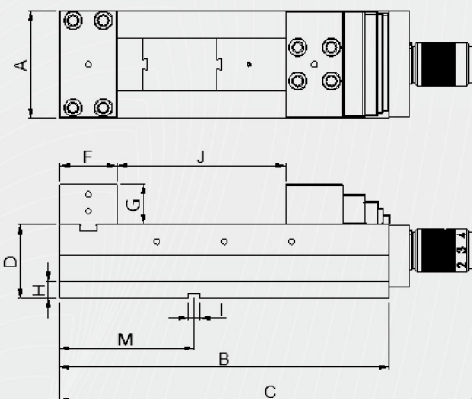

Four clamping ways for choice

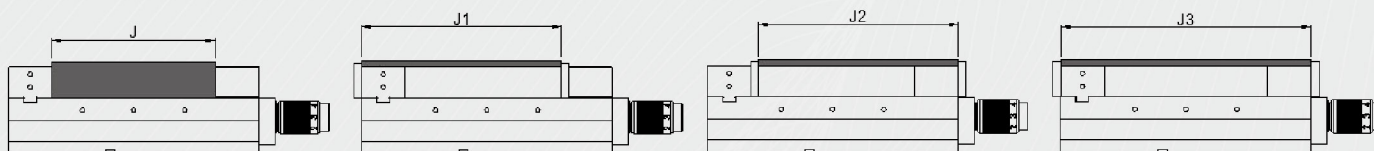

Features

- ▶ The vise is made by precision and grinding processes, it's suitable for vertical / horizontal machine centers.
- ▶ Vise body material is high ductility of spherical graphite cast iron (FCD600) integral product design, vise both sides of the slide hardened heat (HRC50°), ensure high precision and high wear resistance, high tensile strength.
- ▶ Fixed block and sliding block are steel and heat treatment HRC 50° or more, hardness and wear resistance is high, user may add or replace the processing needs of different specifications of the jaw plate.
- ▶ Mechanism design (patented design), with rapid pressurization and high clamping force of the unique characteristics of the pressuring mechanism (highest up to 5500 kgf).
- ▶ The vise has four clamping ways for client to choice.
- ▶ The vise with anti-litter design prevents iron filings drop into the vise, and iron filings easily discharged inside the interior and extend its lifetime.
- ▶ These vises have fixed specifications. Many vises will be used together at the same time.

Standard Accessories

- Ratchet handle x1 pc
- Adapter x1 pc
- Guide key x2 pcs
- Screw M6x12L x2 pcs
- Vise locked block x4 pcs



MODEL	A	B	C	D	F	G	H	I	M	J	J ₁	J ₂	J ₃	Clamping Force kgf	G.W. KG
AFPV-100	100	310	442	85	75	50	25	18	110	150	210	210	300	3500	30
AFPV-130	130	410	542	100	80	55	25	18	135	240	300	300	400	4500	45
AFPV-160	160	490	625	110	85	60	25	18	200	300	380	380	480	5000	64
AFPV-160L	160	550	685	110	85	60	25	18	200	360	440	440	540	5000	69
AFPV-200	200	530	655	110	85	60	25	18	220	350	420	420	520	5500	86

CNC PRECISION MACHINE VISE



MFV

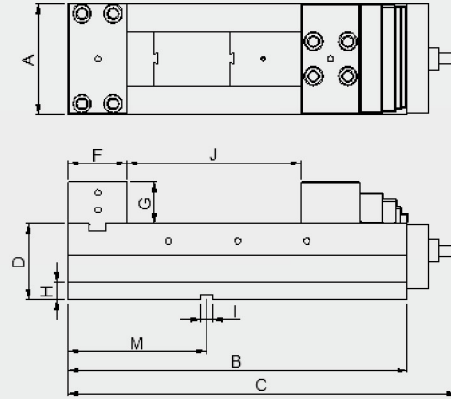

Four clamping ways for choice

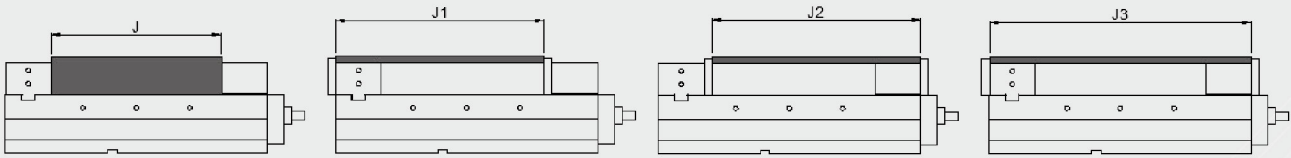

Features

- ▶ The vise is made by precision and grinding processes, it's suitable for vertical / horizontal machine centers.
- ▶ Vise body material is high ductility of spherical graphite cast iron (FCD600) integral product design, vise both sides of the slide hardened heat (HRC50 °), ensure high precision and high wear resistance, high tensile strength.
- ▶ The vise has four clamping way for client to choice.
- ▶ The vise with anti-litter design prevents iron filings drop into the vise, and iron filings easily discharged and extend the period of use.
- ▶ These vises have fixed specifications. Many vises will be used together at the same time.

Standard Accessories

- Handle x1 pc
- Guide key x2 pcs
- Screw M6x12L x2 pcs
- Vise locked block x4 pcs

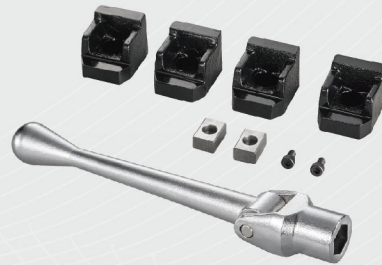

MODEL	A	B	C	D	F	G	H	I	M	J	J ₁	J ₂	J ₃	G.W. KG
MFV -100	100	310	400	85	75	50	25	18	110	150	210	210	300	29
MFV -130	130	410	500	100	80	55	25	18	135	240	300	300	400	44
MFV -160	160	490	580	110	85	60	25	18	200	300	380	380	480	63
MFV-160L	160	550	640	110	85	60	25	18	200	360	440	440	540	68
MFV -200	200	530	620	110	85	60	25	18	220	350	420	420	520	85

DOUBLE LOCK MACHINE VISE (ANGLE LOCK)



Five clamping ways for choice

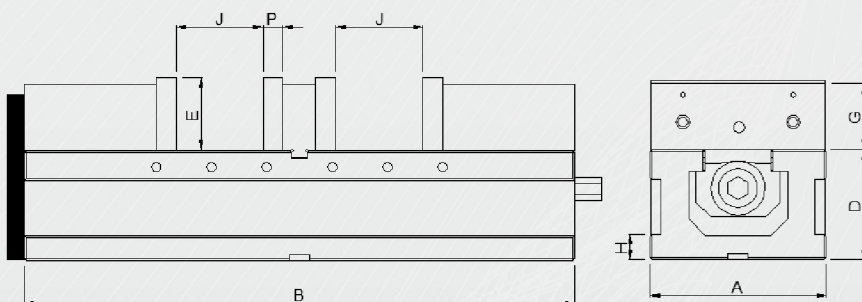
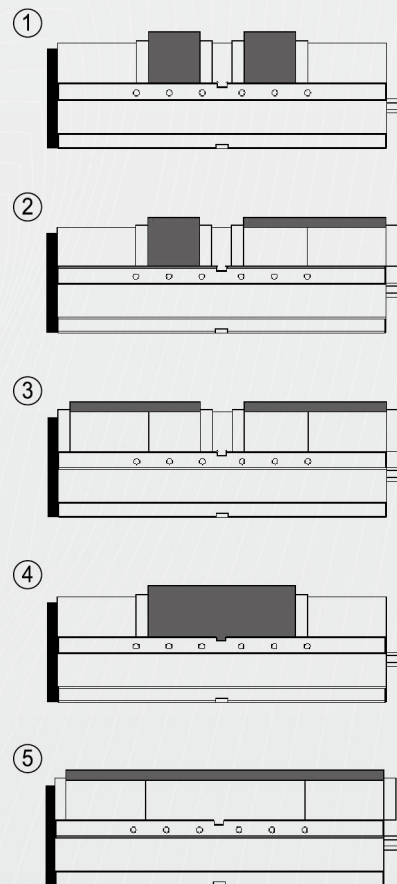

Features

- ▶ Double clamping mechanism, unilateral opening can be adjusted with the range, do two simultaneous machining workpieces of different sizes.
- ▶ When the case of a larger workpiece, the original opening is no insufficient clamp, you can dismantle the middle of the clamping jaw to increase clamping distance.
- ▶ Vise body material is high ductility of spherical graphite cast iron (FCD600), vise both sides of the slide hardened heat (HRC50°), ensure high precision and high wear resistance, high tensile strength.
- ▶ Angle lock semi-sphere can be generated under the power of the lock, remove workpiece to be lifted.
- ▶ The vise has five clamping ways.
- ▶ The vise with anti-litter design prevents iron filings into the vise, and iron filings easily discharged inside the interior and extend its lifetime.

Standard Accessories

- Handle x1 pc ■ Guide key x2 pcs ■ Screw M6x10L x2 pcs
- Vise locked block x4 pcs

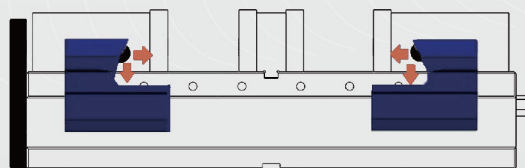
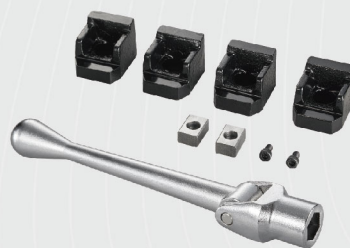

MODEL	A	B	D	E	G	H	P	J	G.W. KG
DPV-160	160	500	100	63	60	23	18	70	64

SEPARATE PRECISION MACHINE VISE

SPPV-160

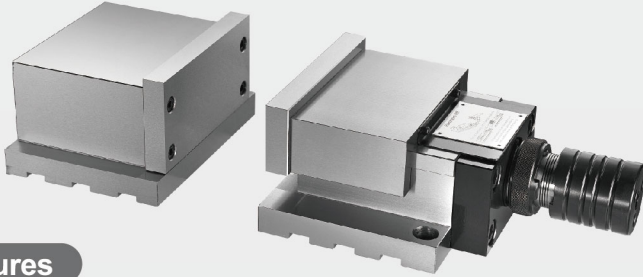

Features

- ▶ The vise is mainly suitable for clamping large workpiece or adjusts the position of clamping, according to the sizes of the workpiece.
- ▶ Angle lock semi-sphere can be generated under the power of the lock, remove the floating workpiece.
- ▶ To put on the workpiece directly for enhancing steady clamp, they are different than other separate vises.
- ▶ Vise body material is high ductility of spherical graphite cast iron (FCD600), vise both sides of the slide hardened heat (HRC50 °), ensure high precision and high wear resistance, high tensile strength.
- ▶ Jaw hardened heat (HRC55 °).

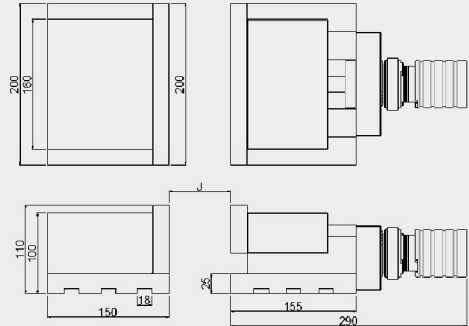

Standard Accessories

- Ratchet handle x1pc ■ Vise locked block x8 pcs
- Guide key x2 pcs ■ Screw M6x10L x2 pcs

MODEL	J	CLAMPING FORCE	STROKE
SPPV-160	To follow the work adjustment opening	3500 kgf	30mm

MPPV-D

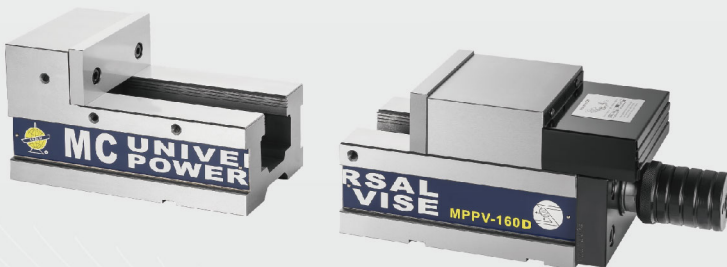

Features

- ▶ The vise is made by precision processing and grinding processes , It can be adjusted clamping length according to the length of work piece.
- ▶ Vise body material is high ductility of spherical graphite cast iron (FCD600), the both sliding sides of vise were hardened by heat (HRC50 °) to ensure high precision and high wear resistance , high tensile strength.
- ▶ Jaw hardened heat is HRC55° °
- ▶ Angle lock semi-sphere can be generated under the power of the lock, it removes the work piece to be lifted.
- ▶ Mechanical Mechanism design (patent design) with rapid pressurization and high clamping force of the unique characteristics of the pressuring mechanism(highest up to 5500 kgf)
- ▶ Theses vises fixed specification (D) .Many vises can be used together at the same time.

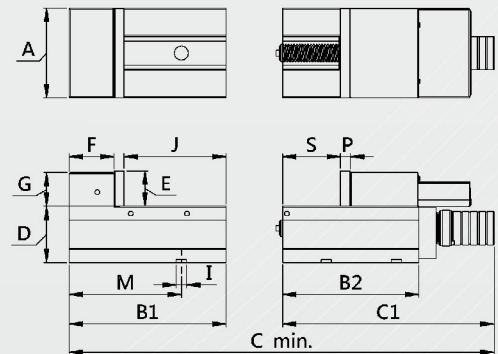

Standard Accessories

- Ratchet handle x1pc ■ Adapter x1 pc
- Guide key x2 pcs ■ Screw M6x12L x2 pcs
- Vise locked block x4 pcs



MODEL	A	B1	B2	C	C1	D	E	F	G	H	I	J	M	P	S	Clamping force kgf	G.W. KG
MPPV-100D	100	173	200	510	335	85	53	60	50	25	18	98	110	15	80	3500	27
MPPV-130D	130	228	220	585	355	100	58	75	55	25	18	138	160	15	90	4500	43
MPPV-160D	160	280	243	660	378	110	63	80	60	25	18	182	200	18	100	5000	61
MPPV-200D	200	324	269	720	404	110	63	95	60	25	18	211	220	18	120	5500	83

QUICK PRECISION VISE

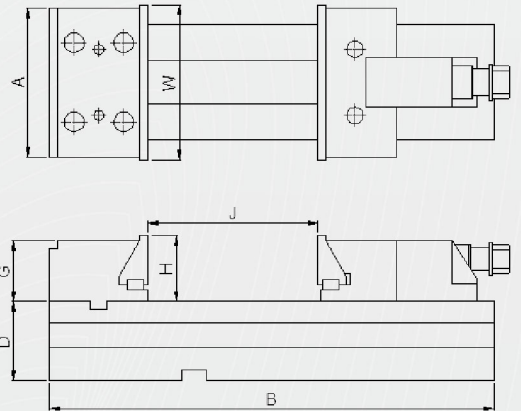
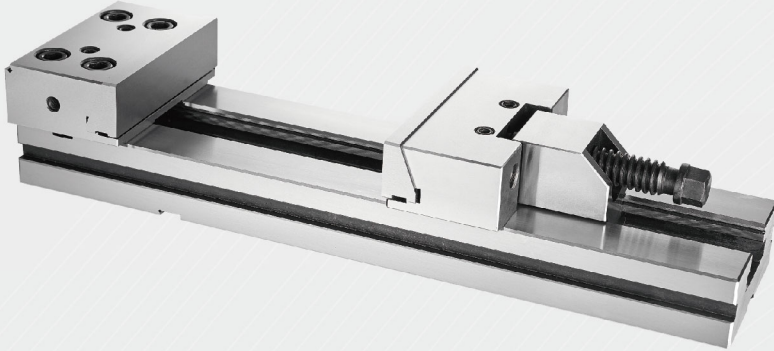

Features

- ▶ Made of high-quality alloy steel.
- ▶ Vise both sides of the slide hardened heat HRC58°~62°.
- ▶ It has interchangeable base, fixed / movable jaw is quick to clamp and easy to operate.
- ▶ It is widely used on machining center and other precision machines.



Standard Accessories

- Handle x1 pc ■ T-Wrench x1 pc
- Guide key x2 pcs ■ Vise locked block x4 pcs

Optional Accessories

- Swivel base x1set

MODEL	A	B	D	G	H	W	J	Weight KG
CGT-100-100	100	270	35	30	30	100	100	12
CGT-125-150	125	345	40	40	40	125	150	19
CGT-150-200	150	420	50	50	50	150	200	34
CGT-150-300	150	520	50	50	50	150	300	38
CGT-175-300	175	555	58	60	60	175	300	57
CGT-200-300	200	595	70	65	65	200	300	90
CGT-200-500	200	795	70	65	65	200	500	104
CGT-300-300	300	635	75	80	80	300	300	120
CGT-300-500	300	835	75	80	80	300	500	160

PS.: To purchase with swivel base is model CGT-100-100B · CGT-125-150B · CGT-150-200B · CGT-150-300B · CGT-175-300B · CGT-200-300B · CGT-200-500B · CGT-300-300B · CGT-300-500B

WISE IN-ROW

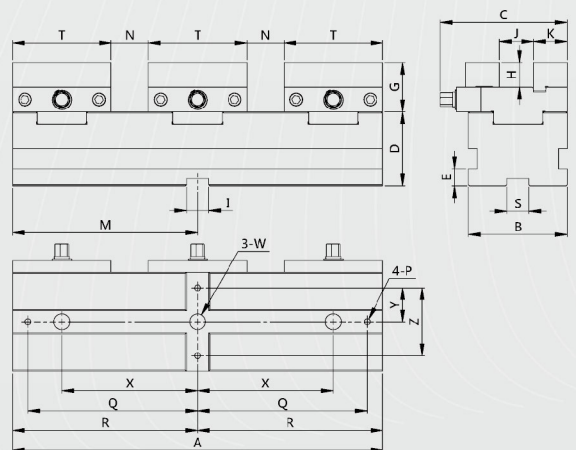
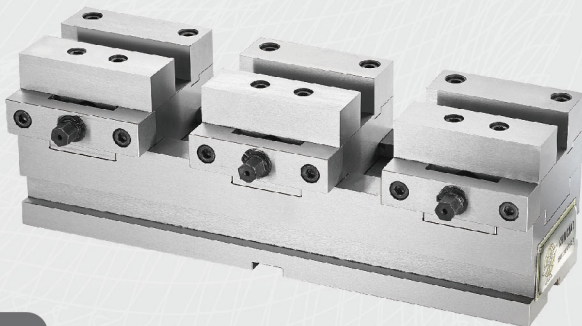

Features

- ▶ Multi grip vise can be clamping multi work pieces and machining with multi work pieces.
- ▶ The whole steel materials are processed by heat treatment and precision grinding to make sure the vise has high accuracy and high wear resistant.
- ▶ It is suitable for machining small work pieces.

Standard Accessories

- Handle x1 pc ■ Guide key x2 pcs ■ Screw M6x12L x2 pcs

MODEL	A	B	C	D	E	G	H	I	J	K	M	N	P	Q	R	S	T	W	X	Y	Z	NW.	GW.
MRV-30080	300	80	103	60	14	40	20	18	27	27.5	150	30	M6	137.5	150	18	80	∅13	110	27.5	55	16Kg	17Kg

MC HYDRAULIC ANGLE LOCK VISE (BUILT-IN TYPE)

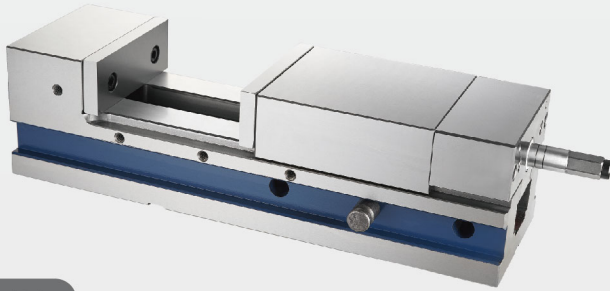

Features

- ▶ Vise body is made of spherical graphite cast iron FCD600.
- ▶ Down thrust with "semi - sphere" to prevent work - piece lifts.
- ▶ Vise can side - lock to work.
- ▶ Vise bed hardened to HRC45°, ensure accuracy and durable.
- ▶ Vise's slid - chuck can take out, it's convenient to clean away iron filings for inside of vise.
- ▶ Vise bed height - size and guide block side are all made with full control, can many vises to work together.

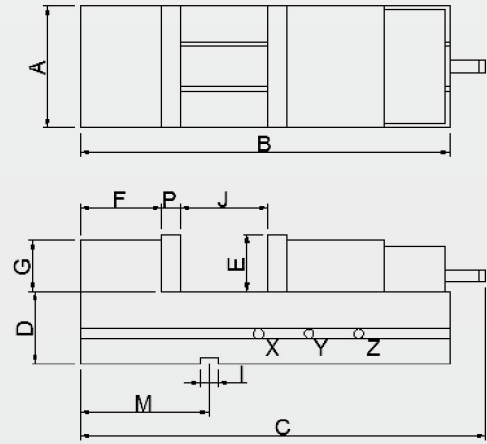

Standard Accessories

■ Handle x1 pc

MODEL	A	B	C	D	E	F	G	I	M	P	Clamping Range J			Clamping Force kgf	G.W. kg
											X	Y	Z		
CMHA-100	105	404	540	62	42	64.5	40	16	122	12.5	0-85	85-170		2500	22
CMHA-150	154	507	710	85	57	84.5	55	18	165	15.5	0-90	90-180	180-270	5000	50
CMHA-200	200	606	755	95	62	89.5	67	18	190	18.5	0-100	100-200	200-300	7000	80

TILTING HYDRAULIC MACHINE VISE

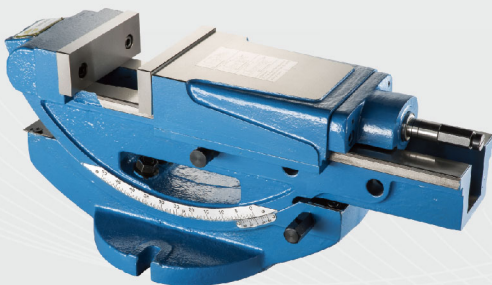

Features

- ▶ The adjustable vise according to the different needs of the processing point of view, vertical angle 0° to 45° can be freely adjusted°, freely adjusted accurately characterize the degree to ensure accuracy.
- ▶ The new hydraulic cylinder with the clamping force is more stable and can resist vibration machines, the possessed easy removal and maintenance of the function, it's economical and durable.
- ▶ Vise body material is high ductility of cast iron, vise both sides of the slide hardened heat (HRC45°), ensure high precision and high wear resistance, high tensile strength.

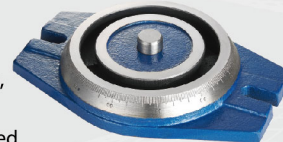
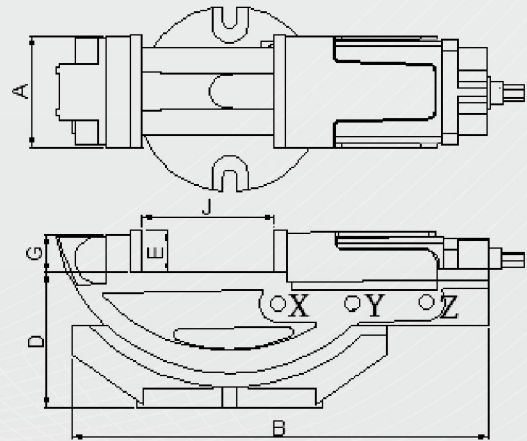

Standard Accessories

■ Handle x1 pc ■ Sleeve x1 pc
■ Connecting rod x1 pc

Optional Accessories

■ Swivel base x1set

MODEL	A	B	D	E	G	Jaw Opening J			Clamping Force kgf	G.W. KG
						X	Y	Z		
HPT-4"	105	395	163	36	34	0-60	60-110	110-170	3500	26
HPT-6"	150	560	250	53	52	0-100	100-200	200-300	4500	71

P.S. : To purchase with swivel base is model HPT-4"-B、HPT-6"-B

HYDRAULIC MACHINE VISE - OUTSIDE

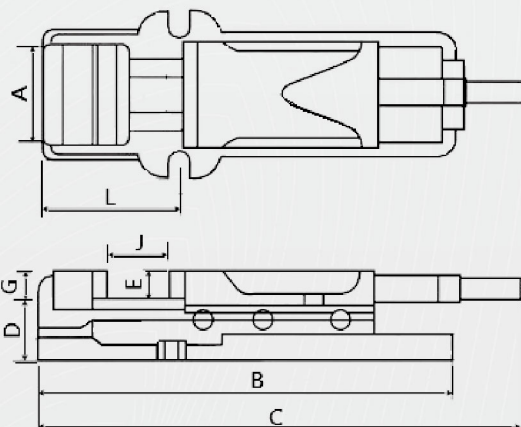

Features

- ▶ Mechanical / hydraulic type can be used alone, or combination, the hydraulic clamping force is stable and big, it's suitable for heavy cutting precision machining.
- ▶ Holder of a large opening function, and can quickly move back and forth.
- ▶ Vise body material is high ductility of cast iron, vise both sides of the slide hardened heat (HRC45°), ensure high precision and high wear resistance, high tensile strength.

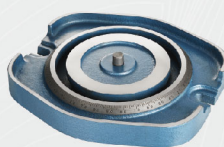

Standard Accessories

- Handle x1 pc

Optional Accessories

- Swivel base x1 set

MODEL	A	B	C	D	E	G	L	J	Clamping Force kgf	G.W. kg
PHV-130	130	505	795	72	55	55	180	220	4000	38
PHV-160	160	605	935	82	58	58	195	310	5000	58
PHV-200	200	700	1035	100	63	63	265	310	6000	95

P.S. : To purchase with swivel base is model PHV-130-B · PHV-160-B · PHV-200-B

HYDRAULIC MACHINE VISE-INSIDE

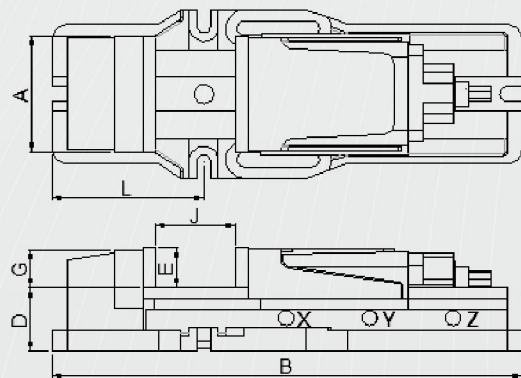

Features

- ▶ The new hydraulic cylinder, with the clamping force is more stable and can resist vibration machines, the function of easy relieve and maintenance. It's economical and durable.
- ▶ Holder of a large opening function and can quickly move back and forth.
- ▶ Vise body material is high ductility of cast iron, vise both sides of the slide hardened heat (HRC45°), ensure high precision and high wear resistance, high tensile strength.

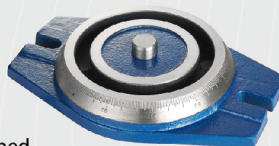

Standard Accessories

- Handle x1 pc
- Sleeve x1 pc
- Connecting rod x1 pc

Optional Accessories

- Swivel base x1 set

MODEL	A	B	D	E	G	L	Jaw Opening J			Clamping Force kgf	G.W. KG
							X Position	Y Position	Z Position		
HP-4"	106	440	58	36	35	147	0-60	60-110	110-170	2500	22
HP-5"	132	550	70.5	48	49.5	195	0-70	70-140	140-220	3000	38
HP-6"	152	620	82.5	53	52.5	210	0-100	100-200	200-300	4500	53
HP-8"	200	680	96	63	60	260	0-100	100-200	200-300	6000	85

P.S. : To purchase with swivel base is model HP-4"-B · HP-5"-B · HP-6"-B · HP-8"-B

MACHINE VISE SERIES

SAV-160A



Features

- ▶ The vise body material is high quality ductility of cast iron FCD60, it has high extensibility and not easy to be deformed.
- ▶ The vise is processed by high precision grinding, it has high accuracy and can be used in-row on work table. The large opening design can reach 225mm distance of clamping.
- ▶ The angle lock semi-round ball can generate down force of angle lock to reduce the floating up of work piece.
- ▶ Both sides of vise sliding are hardened by heat treatment over HRC50°, it can last long wear resistance and high accuracy.

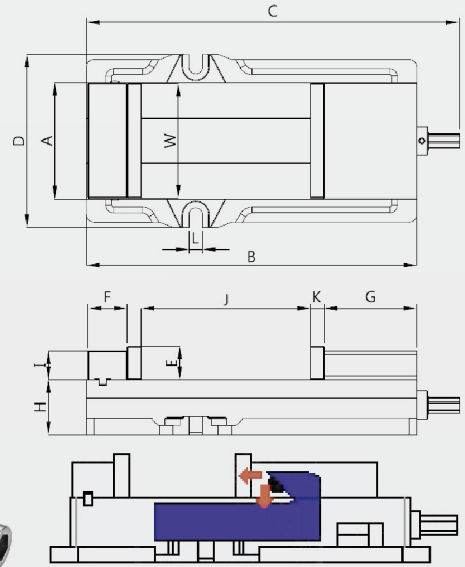

Standard Accessories

- Handle x1 pc

MODEL	A	B	C	D	E	F	G	G.W(KG)
SAV-160A	154	438	494	230	44.5	52	123	35
	H	I	J	K	L	W	Clamping force (MAX)	
	73	38	225	18	18	152	2500kgf	

PRECISION ANGLE LOCK MACHINE VISE

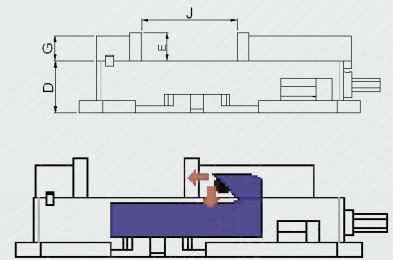
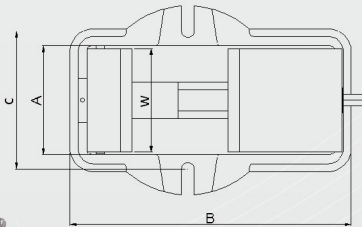
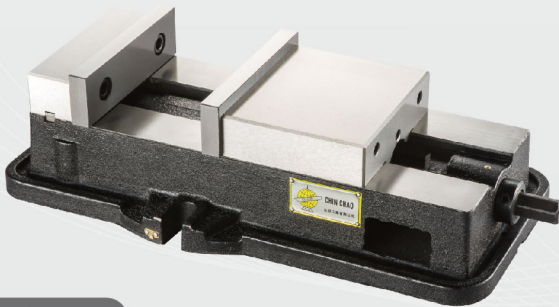

Features

- ▶ Simple structure is economical and durable type of this vise.
- ▶ Angle lock semi-sphere can be generated under the power of the lock, removes the workpiece to be lifted.
- ▶ Vise body material is high ductility of cast iron, vise both sides of the slide hardened heat (HRC45°), ensure high precision and high wear resistance, high tensile strength.



Standard Accessories

- Handle x1 pc

Optional Accessories

- Swivel base x1set

MODEL	A	B	D	E	G	W	J	Clamping force(MAX)	G.W (KG)
SAV-4"	106	320	60	36	28	102	100	1800kgf	15
SAV-5"	136	353	66	36	32	132	110	2000kgf	23
SAV-6"	152	416	72	48	40	152	150	2500kgf	31
SAV-6-1/2"	154	448	68	50	38	152	200	2500kgf	33
SAV-8"	200	553	85	60	52	202	200	3000kgf	59

PS. : To purchase with swivel base is model SAV-4"-B、SAV-5"-B、SAV-6"-B、SAV-6-1/2"-B、SAV-8"-B

MACHINE VISE SERIES

UT-TECH PRECISION INDUSTRIAL CO., LTD.

www.ut-tech.com.tw

SMC

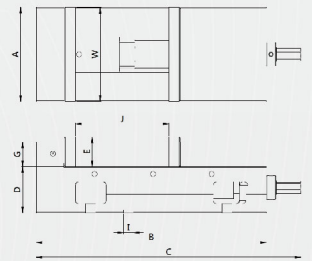
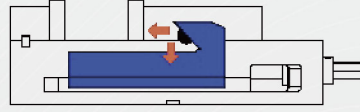
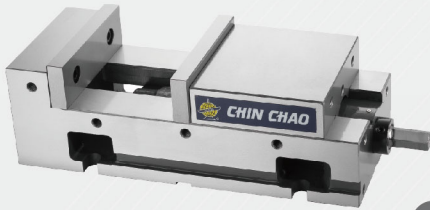

Features

Standard Accessories

■ Handle x1 pc

- ▶ This product has been six surface grinding, high accuracy, dual-use includes parallel and side to be cross-functional than the traditional angle lock vise better.
- ▶ Angle lock semi-sphere can be generated under the power of the lock, removes the workpiece to be lifted.
- ▶ Vise body material is high ductility of cast iron, vise both sides of the slide hardened heat (HRC45°), ensure high precision and high wear resistance, high tensile strength.

MODEL	A	B	C	D	E	G	I	J	W	Clamping force max	kg
SMC-6"	153	374	430	75	48	40	16	152	152	2500kgf	32

LOCK-FIXED PRECISION MACHINE VISE

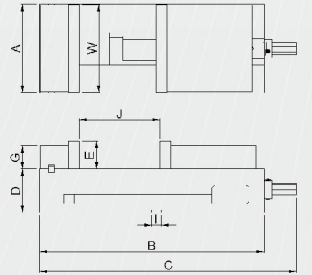
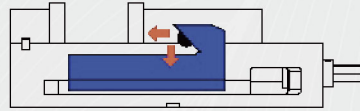
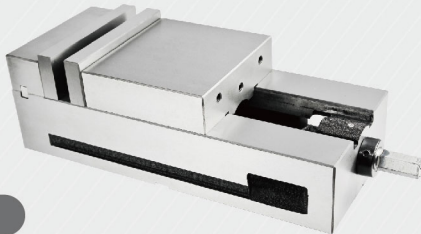

Features

Standard Accessories

■ Handle x1 pc

- ▶ This product has been six surface grinding, high accuracy, dual-use includes parallel and side to be cross-functional than the traditional angle lock vise better.
- ▶ Angle lock semi-sphere can be generated under the power of the lock, removes the workpiece to be lifted.
- ▶ Vise body material is high ductility of cast iron, vise both sides of the slide hardened heat (HRC45°), ensure high precision and high wear resistance, high tensile strength.

MODEL	A	B	C	D	E	G	I	W	J	Clamping force (MAX)	G.W(KG)
MC-4"	106	280	324	58	36	28	16	102	100	1800kgf	13
MC-5"	134	310	357	64	36	32	16	132	100	2000kgf	19
MC-6"	153	368	424	75	48	40	16	152	150	2500kgf	30
MC-8"	204	493	551	82	60	52	16	202	200	3000kgf	62

LONG JAW ANGLE LOCK MACHINE VISE

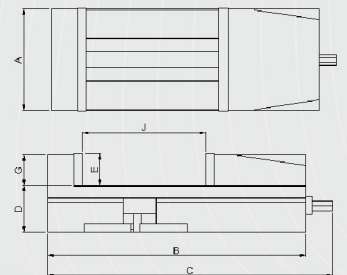
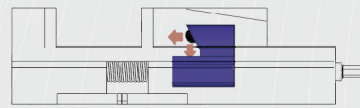
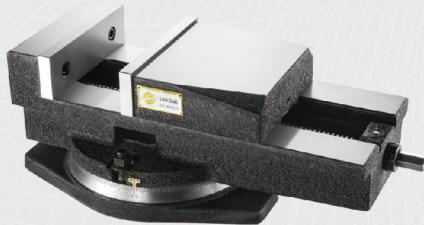

Features

Standard Accessories

Optional Accessories

■ Handle x1 pc

■ Swivel base x1 set

- ▶ This item vise clamp have a large opening, and vise processed by integrally molded body, the combination can reduce the tolerances and deformation, and vise body structure is more robust.
- ▶ Angle lock semi-sphere can be generated under the power of the lock, removes the workpiece to be lifted. Simple structure is economical and durable type of this vise.
- ▶ Vise body material is high ductility of cast iron, vise both sides of the slide hardened heat (HRC45°), ensure high precision and high wear resistance, high tensile strength.

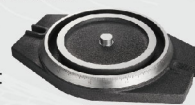

MODEL	A	B	C	D	E	G	J	G.W. KG
XL-8"	200	510	560	92	63	60	260	72

P.S. : To purchase with swivel base is model XL-8"-B

K-TYPE SUPER OPEN MILLING VISE

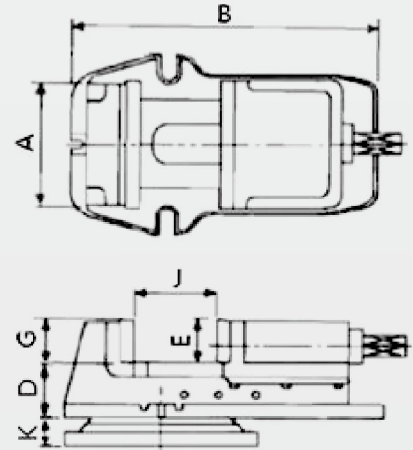

Features

- ▶ This is big opening for clamp function. Structure is simple, it's economical and durable.
- ▶ Vise body material is high ductility of cast iron, vise both sides of the slide hardened heat (HRC45 °), ensure high precision and high wear resistance, high tensile strength.

Standard Accessories

- Handle x1 pc

Optional Accessories

- Swivel base x1set

MODEL	A	B	D	E	G	K	J	G.W. KG
J-400	110	390	58	38	37	41	180	21
J-500	130	450	66	49	48	42	230	32
J-600	152	540	77	54	54	42	300	45

PS. : To purchase base model J-400-B · J-500-B · J-600-B

2-WAY MACHINE VISE

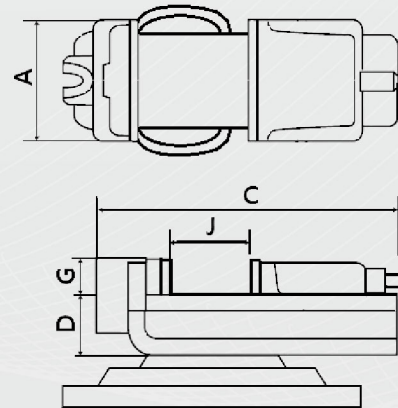

Features

- ▶ The adjustable vise accords to the different needs of the processing point of view, the swivel base it can rotate 360°, the vertical direction adjusts the angle from 0° to 30°, freely adjusted accurately characterize the degree to ensure accuracy.
- ▶ Vise body material is high ductility of cast iron, vise both sides of the slide hardened heat (HRC45 °), ensure high precision and high wear resistance, high tensile strength.

Standard Accessories

- Handle x1 pc
- Swivel base x1set

MODEL	A	C	D	G	J	G.W. KG
CU-6"	150	460	65	43	130	45

3-WAY ANGLE MILLING VISE

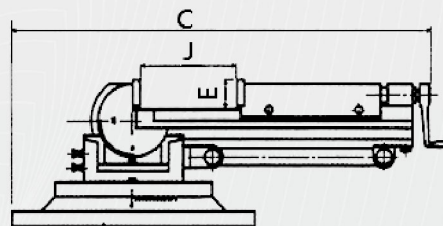
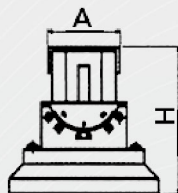

Features

- ▶ Angle can be set in three different directions, the plane of rotation up to 360°, vertical angle can be raised from 0° to 90° the tilt angle part can rotate around 45° degrees and accurate characterization to ensure accuracy.
- ▶ Remain stable smooth at any angle tilt for the workpiece.
- ▶ Have auxiliary rod, the workpiece allows more stable during machining.

Standard Accessories

- Handle x1 pc
- Swivel base x1 set

MODEL	A	C	E	H	J	Vertical Height	G.W. KG
CY-3"	80	400	30	144	90	385	17
CY-4"	106	460	38	172	100	470	32
CY-5"	132	625	40	205	140	590	51

K-TYPE MILLING VISE

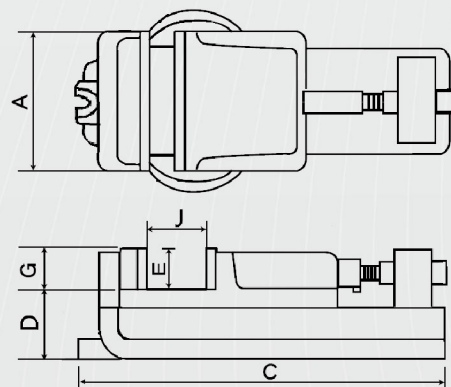
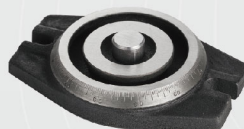
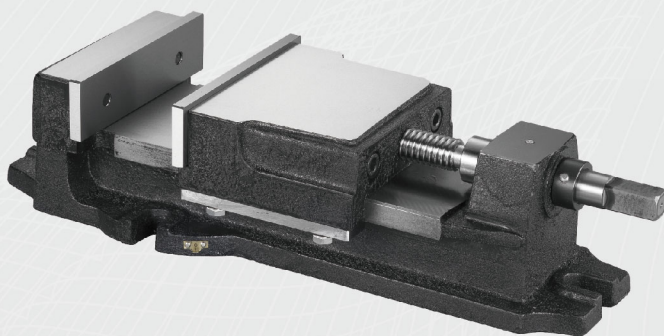

Features

- ▶ Simple structure, is economical and durable type of this vise.
- ▶ Vise body material is high ductility of cast iron, vise both sides of the slide hardened heat (HRC45 °), ensure high precision and high wear resistance, high tensile strength.

Standard Accessories

- Handle x1 pc

Optional Accessories

- Swivel base x1 set

MODEL	A	C	D	E	G	J	G.W. KG
SKV-4"	97	294	48	34	32	60	10
SKV-5"	125	368	60	36	34	80	16
SKV-6"	150	460	65	43	43	110	27
SKV-8"	200	620	85	63	60	150	58

P.S.: To purchase base model SKV-4"-B · SKV-5"-B · SKV-6"-B · SKV-8"-B

HIGH QUALITY CLAMP-UNIT - SV

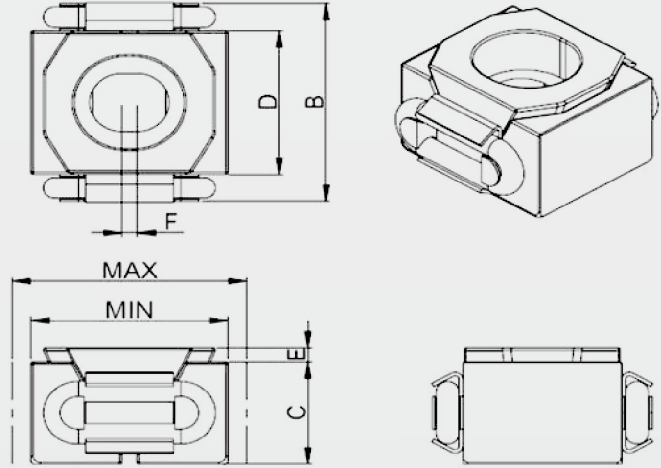
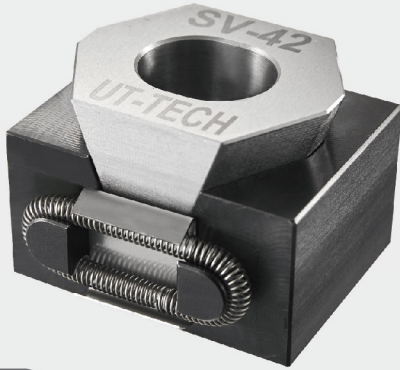

Features

- ▶ Suitable for high precision machining work.
- ▶ High wear-resistance, precision and anti-tension features.
- ▶ Special design for stabilizing work piece.
- ▶ Can be used for variety of work piece.

Model	LONG (MIN)	LONG (Optimum)	LONG (MAX)	B	C	D	E	F	(Socket Head Screw)
SV-27	26	29	31	29	26	21	2.1	2.0	M8 x 020
SV-42	42	48	53	46	22	32	8.8	2.0	M12 x 030
SV-57	57	61	66	56.6	28.5	42	4.0	3.0	M16 x 040

PRECISION MACHINE VISE SPECIAL APPLICATION JAW PLATES

Features

- ▶ It applies in power machine vises. According different workpieces to use suitable clamp jaw for enhance processing more effective.

J1

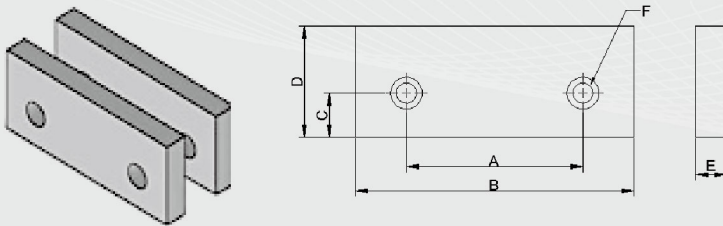

MODEL	A	B	C	D	E	F
J1-100	70	98	25	53	15	M10
J1-130	90	128	25	58	15	M10
J1-160	100	158	25	63	18	M10
J1-200	120	198	30	63	18	M12

J2

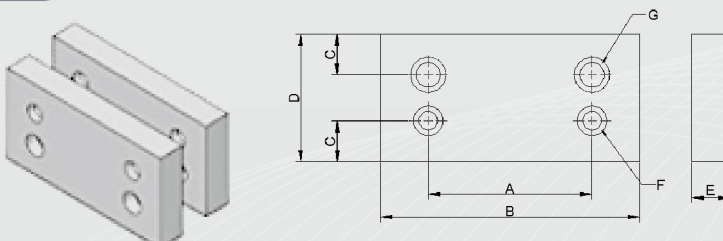

MODEL	A	B	C	D	E	F	G
J2-100	70	98	25	73	20	M10	M12
J2-130	90	128	25	73	20	M10	M12
J2-160	100	158	25	78	23	M10	M12
J2-200	120	198	30	85	23	M12	M14

PRECISION MACHINE VISE SPECIAL APPLICATION JAW PLATES

Features

▶ It applies in power machine vises. According different workpieces to use suitable clamp jaw for enhance processing more effective.

J3

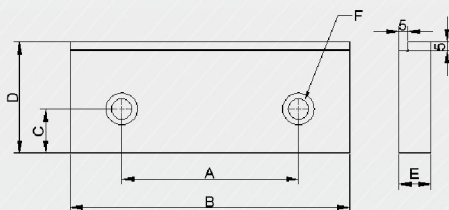
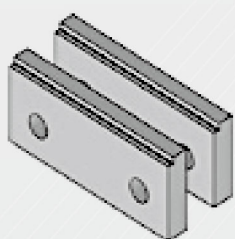

	C	A	B	C	D	E	F
J3-100	70	98	25	53	15	M10	
J3-130	90	128	25	58	15	M10	
J3-160	100	158	25	63	18	M10	
J3-200	120	198	30	63	18	M12	

J4

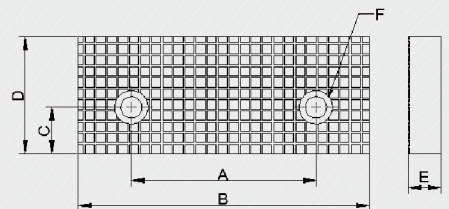
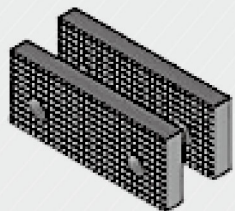

MODEL	A	B	C	D	E	F
J4-100	70	98	25	53	15	M10
J4-130	90	128	25	58	15	M10
J4-160	100	158	25	63	18	M10
J4-200	120	198	30	63	18	M12

J5

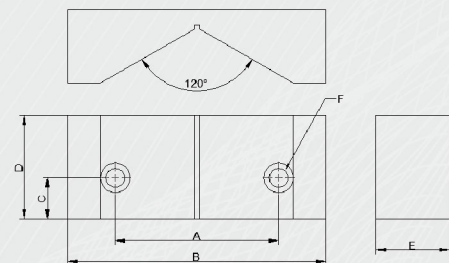
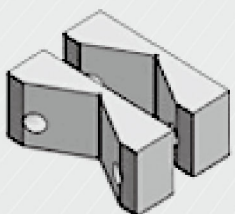

MODEL	A	B	C	D	E	F
J5-100	70	98	25	53	30	M10
J5-130	90	128	25	58	30	M10
J5-160	100	158	25	63	45	M10
J5-200	120	198	30	63	45	M12

J6

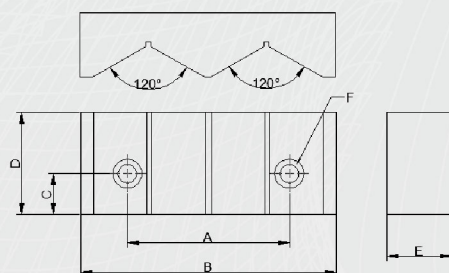
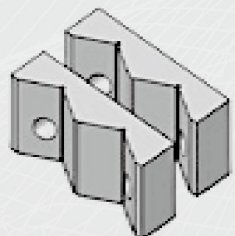

MODEL	A	B	C	D	E	F
J6-100	70	98	25	53	30	M10
J6-130	90	128	25	58	35	M10
J6-160	100	158	25	63	40	M10
J6-200	120	198	30	63	40	M12

J7

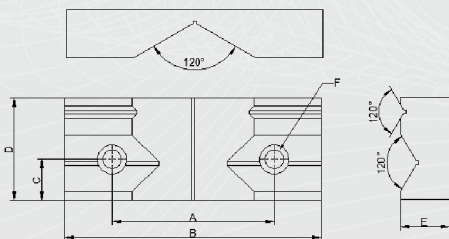
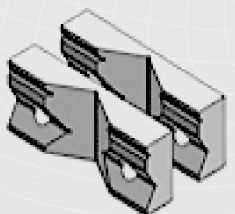

MODEL	A	B	C	D	E	F
J7-100	70	98	25	53	30	M10
J7-130	90	128	25	58	30	M10
J7-160	100	158	25	63	30	M10
J7-200	120	198	30	63	40	M12

www.ut-tech.com.tw

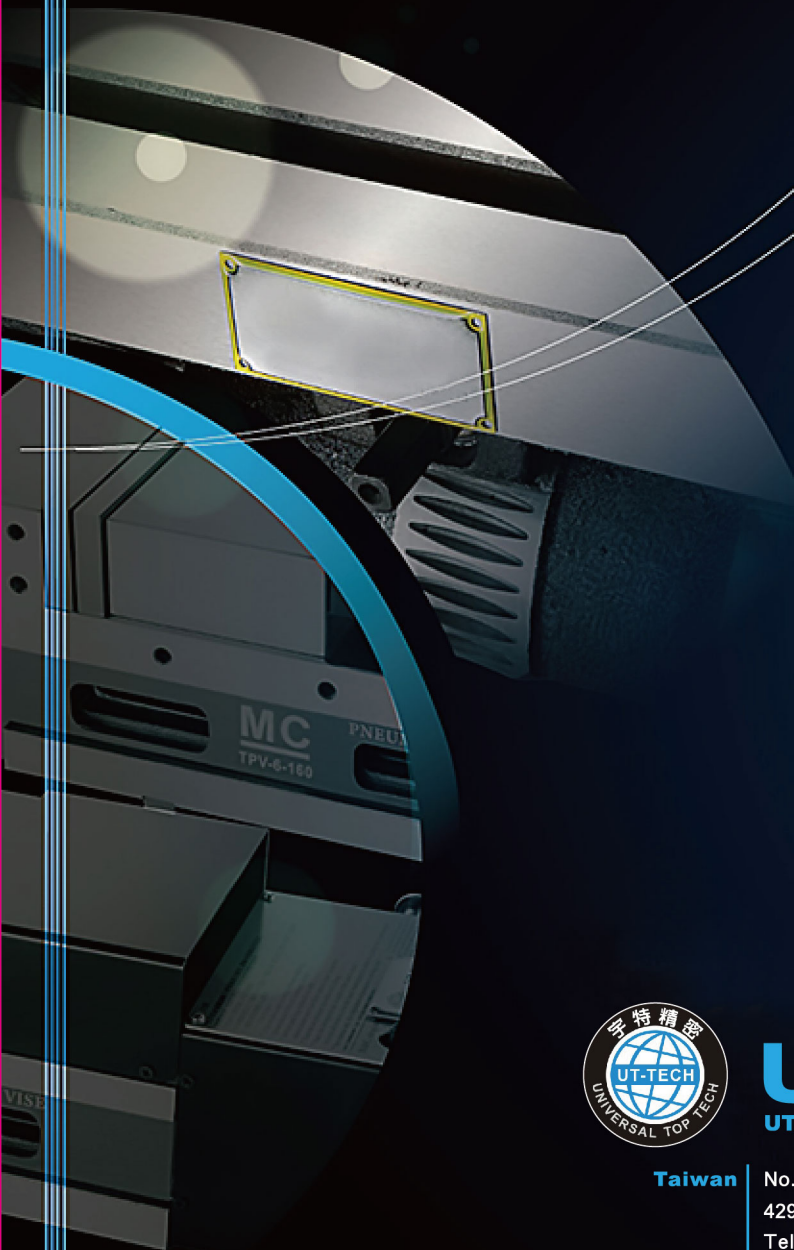

UT-TECH

UT-TECH PRECISION INDUSTRIAL CO., LTD.

Taiwan

No.174, Daming Rd., Shengang Dist., Taichung City
429, Taiwan (R.O.C.)
Tel : +866-04-25276878
Fax : +866-04-25206919
E-mail : service@chin-chao.com.tw

China

No.6,Haibin Road,Wusha Chang'an Town,Dongguan City,
Guangdong Province
Tel : +86-13058569292

BROTECH