

Фрезерные керамические пластины и корпуса



CONTENTS

01 Milling Grade	3
02. Milling Insert	6
03. Milling Cutter (Face Milling)	13
04. Arbor	31

01. MILLING GRADE

- Ceramic Grade for Workpiece
- Chamfer Specification

■ Ceramic Grade for Workpiece



Workpiece		CAT10, CAT30 CAT10C, CAT30C CAT30MC	CAT50 CAT90 CAT90C	CAT20	CA20 CA30	CSN20, CSN30, CSN40 CSN50, CSN60 CSN40C, CSN60C	CSN80	CSN95 CSN100 CSN100C	CW40 CW40C	CW80 CW80C
Cast Iron	Gray cast iron	◎	○	○	◎	◎	◎	○		
	Chilled cast iron	○	○		○	○	◎	○		
	Ductile cast iron	○		◎		○	○	○		
Steel	Mild steel	○			○					
	Carbon steel	○			○					
	Alloy steel	◎	○		○		○	○	○	○
	Forged steel	○	◎							
	Heat treated steel	○	◎							
	High speed steel	○	◎						◎	○
	High manganese steel	○	○			○	○	○	◎	○
	Stainless steel									
	Heat resistant super alloy						○	◎	○	◎

◎ : Excellent ○ : Good

Grade	Workpiece	Machining Type	Speed (V) (m/min)	Feed (f) (mm/teeth)	Depth (DOC) (mm)
CSN20 CSN30 CSN40	Gray Cast Iron (FC)	Rough	100 ~ 1,200	0.3 ~ 0.5	< 5
		Finish	150 ~ 1,500	0.3 ~ 0.7	< 3
CSN50 CSN60 CSN40C CSN60C	Ductile Cast Iron Alloy Steel	Rough	90 ~ 500	0.1 ~ 0.3	< 5
		Finish	100 ~ 700	0.1 ~ 0.4	< 3
CSN80 CSN100	High temperature alloys Inconel Stellite	Finish	700 ~ 1,000	0.05~0.15	0.5~2.5
CW40 CW80 CW40C CW80C	High temperature alloys Inconel Incotel	Rough	150 ~ 400	0.05~0.15	1~3

■ Chamfer Specification

1. Mono Chamfer

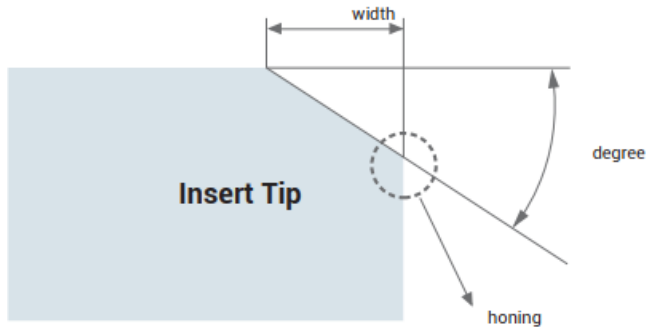

SNGN 120408 E 0 4 0

Chamfer Degree (°)	Chamfer Width (mm)		Honing (μm)
E : 20	01 : 0.05	10 : 0.50	0 : No Honing
F : 25	02 : 0.10	20 : 1.00	1 : 10
G : 30	03 : 0.15	40 : 2.00	2 : 20
	04 : 0.20		3 : 30

2. Double Chamfer

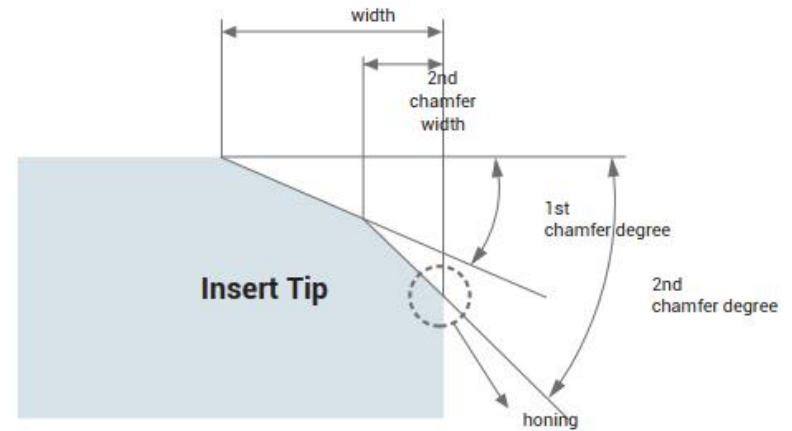

ISO

SNGN 190716 X 5 4 2

1st Chamfer Degree (°)	1st Chamfer Width (mm)		2nd Chamfer Width(mm)×Degree		Honing (μm)
W : 10	3 : 1.00	A : 0.75	3 : 0.20×25	A : 0.15×30	0 : No Honing
X : 15	4 : 1.20	B : 1.25	4 : 0.10×30	B : 0.45×25	1 : 10
	5 : 1.50	D : 2.30	5 : 0.20×30		2 : 20
	6 : 2.00				3 : 30
					5 : 50

02. MILLING INSERT

HNEN

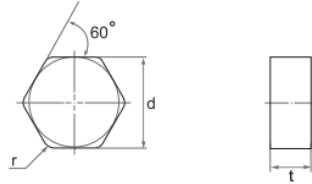

Type	Dimensions (mm)		
ISO	d	t	r
HNEN 090520	16.20	5.56	2.0
HNEN 090530	16.20	5.56	3.0
HNEN 0905 ANSN	15.87	5.64	0.8

LNE

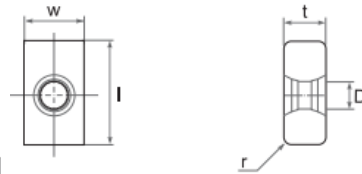

Type	Dimensions (mm)					
ISO	l	w	t	D	r	
LNE 040904	15.87	9.52	4.76	4.41	0.4	
LNE 040908	15.87	9.52	4.76	4.41	0.8	
LNE 040912	15.87	9.52	4.76	4.41	1.2	
LNE 1007	15.67	9.52	6.35	4.10	1.2	

OEGB

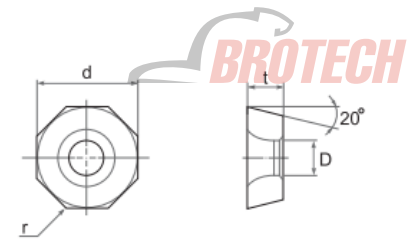

Type	Dimensions (mm)			
ISO	d	t	D	r
OEGB 070408	15.87	4.76	5.18	0.8
OEGB 070416	15.87	4.76	5.18	1.6

OEGB .. CR

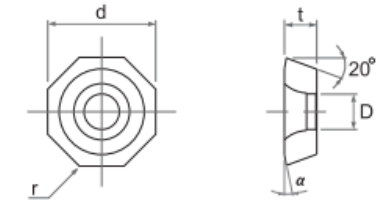

Type	Dimensions (mm)					
ISO	d	t	D	r	alpha	
OEGB 070408 0003 CR	15.87	4.76	5.18	0.80	10°	
OEGB 070416 0003 CR	15.87	4.76	5.18	1.60	10°	
OEGB 070516 0003 CR	15.87	5.56	5.18	1.60	10°	

OPEN

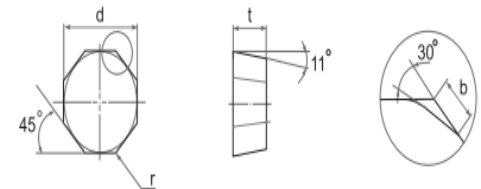

Type	Dimensions (mm)			
ISO	d	t	r	b
OPEN 050408 TR	13.97	4.76	0.80	2.10
OPEN 050608 TR	13.97	6.35	0.80	2.10

SNCN

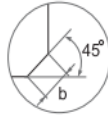

Type		Dimensions (mm)		
ISO	ASA	d	t	b
SNCN 1204 AN	SNCN 43 AN	12.70	4.76	2.50
SNCN 1204 ZN	SNCN 43 ZN	12.70	4.76	1.10

SNCN .. ENTN

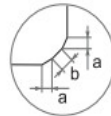
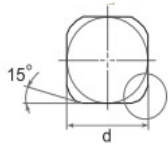

Type		Dimensions (mm)			
ISO	ASA	d	t	a	b
SNCN 1204 ENTN	SNCN 43 ENTN	12.70	4.76	1.40	1.00
SNCN 1504 ENTN	SNCN 53 ENTN	15.87	4.76	1.40	1.00

SNGN .. ING



Type		Dimensions (mm)		
ISO	ASA	d	t	b
SNGN 1204 ING	SNGN 43 ING	12.70	4.76	1.50
SNGN 1904 ING	SNGN 63 ING	19.05	4.76	2.50

SDCN

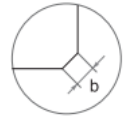
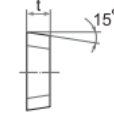
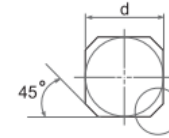

Type		Dimensions (mm)		
ISO	ASA	d	t	b
SDCN 1203 AETN T2	SDCN 42 AETN T2	12.70	3.18	1.2
SDCN 1203 AETN	SDCN 42 AETN	12.70	3.18	2.0
SDCN 1504 AETN	SDCN 53 AETN	15.87	4.76	2.0

SDCN .. T

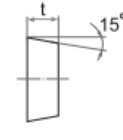
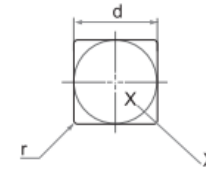

Type		Dimensions (mm)		
ISO	ASA	d	t	r
SDCN 120408 T20	SDCN 432 T20	12.70	4.76	0.8
SDCN 120412 T20	SDCN 433 T20	12.70	4.76	1.2

SDCW

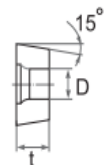
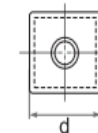
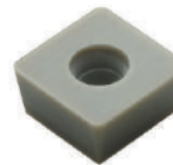

Type		Dimensions (mm)		
ISO	ASA	d	t	D
SDCW 1204 PDSR	SDCW 43 PDSR	12.70	4.76	4.40

SEAN

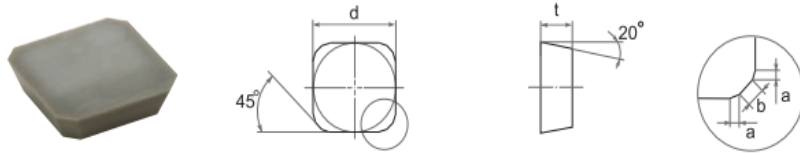

Type		Dimensions (mm)			
ISO	ASA	d	t	a	b
SEAN 1203 AFTN	SEAN 42 AFTN	12.70	3.18	0.50	1.80
SEAN 1504 AFTN	SEAN 53 AFTN	12.70	4.76	0.70	2.00

SEAN .. NW

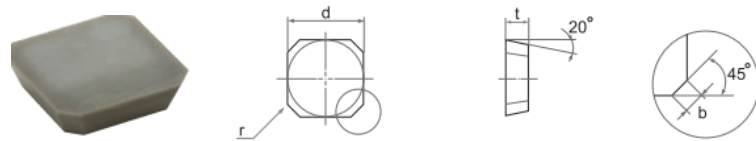

Type		Dimensions (mm)			
ISO	ASA	d	t	b	r
SEAN 1203 NWAFTN	SEAN 42 NWAFTN	12.70	3.18	2.40	0.4
SEAN 1204 AFTNW25	SEAN 43 AFTNW25	12.70	4.76	2.50	1.2

SEAN .. T

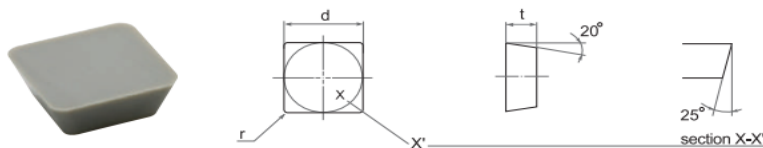

Type		Dimensions (mm)			
ISO	ASA	d	t	r	
SEAN 120412 T25	SEAN 433 T25	12.70	4.76	1.2	
SEAN 120416 T25	SEAN 434 T25	12.70	4.76	1.6	

SPCN .. T

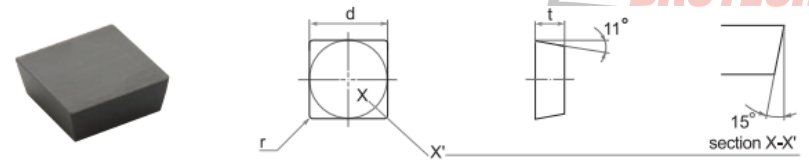

Type		Dimensions (mm)		
ISO	ASA	d	t	r
SPCN 120412 T15	SPCN 433 T15	12.70	4.76	1.2
SPCN 120416 T15	SPCN 434 T15	12.70	4.76	1.6

SPCW



Type		Dimensions (mm)		
ISO	ASA	d	t	D
SPCW 10T3ZX	SPCW 10T3ZX	10.00	3.97	3.52

SPEN

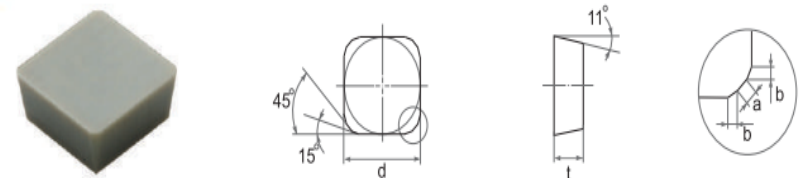

Type		Dimensions (mm)			
ISO	ASA	d	t	a	b
SPEN 1206 APTN	SPEN 44 APTN	12.70	6.35	1.20	1.20

SPHX

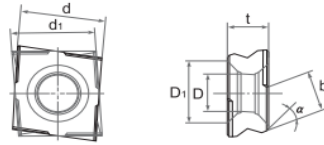
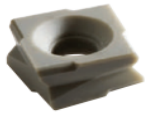

Type	Dimensions (mm)						
ISO	d	d ₁	t	D	D ₁	a	b
SPHX 1205NR 480T	11.67	11.33	5.50	5.10	8.41	45	8.0
SPHX 1205NL 480T	11.67	11.33	5.50	5.10	8.41	45	8.0
SPHX 1205ER 855T	12.09	11.33	5.50	5.10	8.41	35	5.50
SPHX 1205EL 855T	12.09	11.33	5.50	5.10	8.41	35	5.50
SPHX 15T6NR 880T	14.58	14.33	6.60	6.10	10.18	45	8.80
SPHX 15T6ER 865T	15.50	14.33	6.60	6.10	10.18	35	6.50

SPKN



Type		Dimensions (mm)				
ISO	ASA	d	t	a	b	
SPKN 1203 EDTR	SPKN 42 EDTR	12.70	3.18	1.40	1.00	
SPKN 1504 EDTR	SPKN 53 EDTR	15.87	4.76	1.40	1.00	

SPKN .. SP

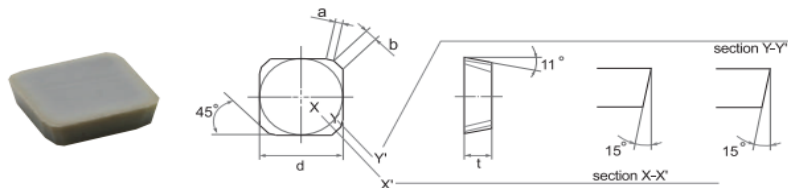

Type		Dimensions (mm)				
ISO	ASA	d	t	a	b	
SPKN 1204SP EDTR	SPKN 43SP EDTR	12.70	4.76	1.10	1.30	

TNCN

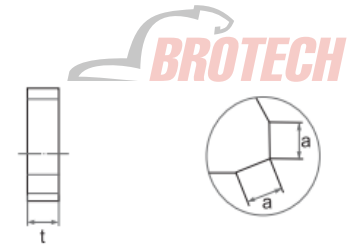

Type		Dimensions (mm)		
ISO	ASA	d	t	a
TNCN 2204 ANT	TNCN 43 ANT	12.70	4.76	2.60

TEKN

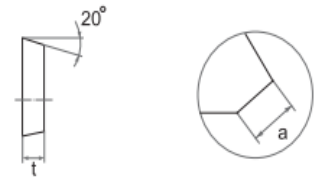
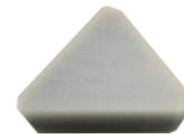

Type		Dimensions (mm)		
ISO	ASA	d	t	a
TEKN 1603 PFTR	TEKN 32 PFTR	9.52	3.18	1.40
TEKN 2204 PFTR	TEKN 43 PFTR	12.70	4.76	2.10

TPKN

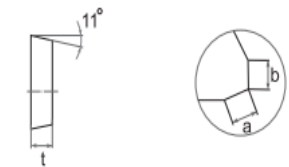

Type		Dimensions (mm)				
ISO	ASA	d	t	a	b	
TPKN 1603 PDTR	TPKN 32 PDTR	9.52	3.18	1.20	1.00	
TPKN 2204 PDTR	TPKN 43 PDTR	12.70	4.76	1.40	0.70	

WIPER INSERT

f : feed (mm)
 r : corner radius
 r_w : wiper radius (large radius)
 R_a : surface finish

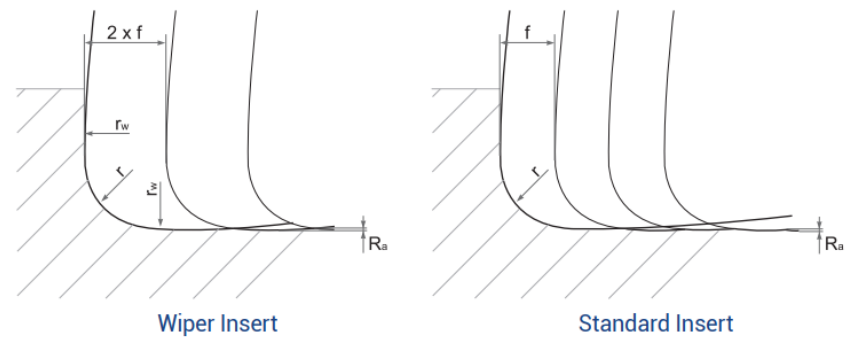

CNGN .. AZ

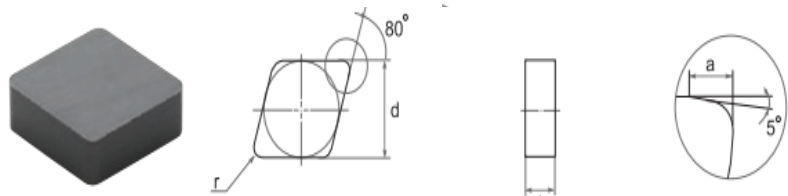

Type		Dimensions (mm)			
ISO	ASA	d	t	r	a
CNGN 1204 AZ	CNGN 43 AZ	12.70	4.76	1.0	1.60

SNCN .. ZZT

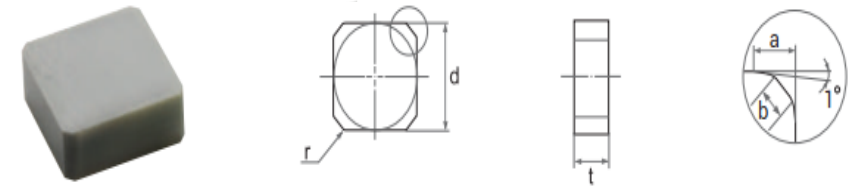

Type		Dimensions (mm)			
ISO	ASA	d	t	a	b
SNCN 0904 ZZT	SNCN 33 ZZT	9.52	4.76	1.30	1.10
SNCN 1204 ZZT	SNCN 43 ZZT	12.70	4.76	3.25	1.10

SNCN .. GZ

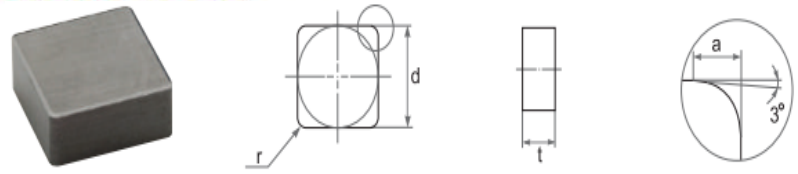

Type		Dimensions (mm)			
ISO	ASA	d	t	a	b
SNCN 0904 GZ	SNCN 33 GZ	9.52	4.76	0.8	1.00

SNCN .. KZ

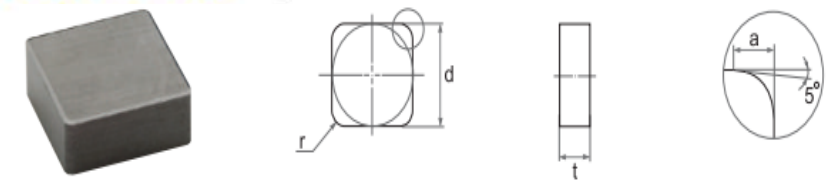

Type		Dimensions (mm)			
ISO	ASA	d	t	a	b
SNCN 1204 KZ	SNCN 43 KZ	12.70	4.76	1.2	1.80

SCGN .. WZ

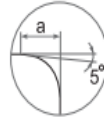
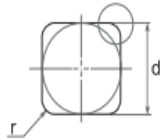

Type		Dimensions (mm)			
ISO	ASA	d	t	a	b
SCGN 0904 WZ	SCGN 33 WZ	9.52	4.76	0.8	1.60
SCGN 1204 WZ	SCGN 43 WZ	12.70	4.76	0.8	1.60

SCGN .. MZ

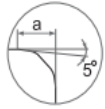
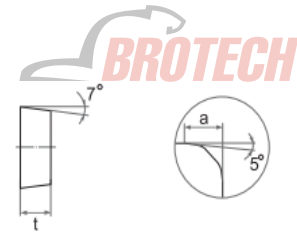
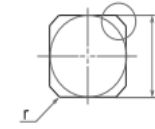

Type		Dimensions (mm)			
ISO	ASA	d	t	a	b
SCGN 0904 MZ	SCGN 33 MZ	9.52	4.76	0.8	1.80
SCGN 1204 MZ	SCGN 43 MZ	12.70	4.76	0.8	1.80

SCGN .. XZ

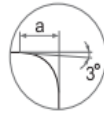
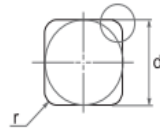

Type		Dimensions (mm)			
ISO	ASA	d	t	a	b
SCGN 0904 XZ	SCGN 33 XZ	9.52	4.76	0.8	1.20
SCGN 1204 XZ	SCGN 43 XZ	12.70	4.76	0.8	1.20

SCGN .. ZM

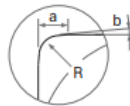
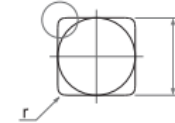
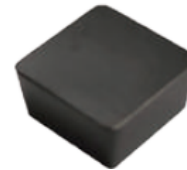

Type		Dimensions (mm)				
ISO	ASA	d	t	a	b	R
SCGN 0904 ZM	SCGN 33 ZM	9.52	4.76	1.23	5°	0.8

SCGN .. ZZ

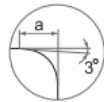
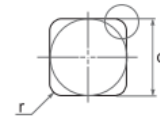
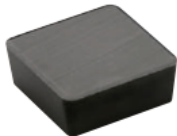

Type		Dimensions (mm)			
ISO	ASA	d	t	a	b
SCGN 0904 ZZ	SCGN 33 ZZ	9.52	4.76	0.8	1.00
SCGN 1204 ZZ	SCGN 43 ZZ	12.70	4.76	0.8	1.00

WIPER INSERT

03. MILLING CUTTER

-FACE MILLING-

SFKN .. 88



SFKN .. 75



SFKN .. 45



Application Index

SFKP .. 88



SFKP .. 75



SFKP .. 45



SFAN .. 88



SFAN .. 75



SFSP .. OT



SFKN .. HX



SFCN .. 00 .. R



SFCP .. 00 .. R



SFXP



SFXN



SEXP



SFKN .. 88



Axial rake angle : -7°

Radial rake angle
D40 : -12°
D50~125 : -10°

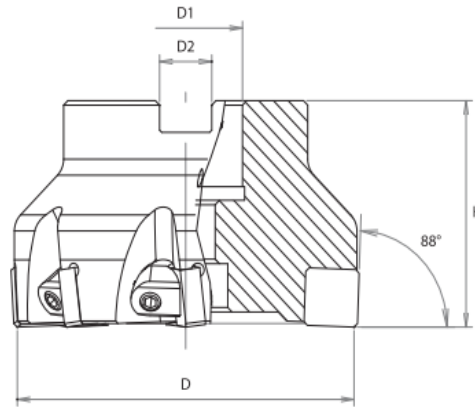

Type	Dimensions (mm)				⚙️	Insert
	D	D ₁	D ₂	H		
SFKN 040-04-88 N4	40	16	8.4	40	4	SNCN 0904 ZZT
SFKN 050-05-88 N4	50	22	10.4	40	5	
SFKN 063-06-88 N4	63	22	10.4	40	6	SNCN 1204 ZZT SNCN 1204 ZN
SFKN 080-08-88 N4A	80	25.4	9.5	50	8	
SFKN 080-08-88 N4	80	27	12.4	50	8	
SFKN 100-10-88 N4A	100	31.75	12.7	50	10	
SFKN 100-10-88 N4	100	32	14.4	50	10	
SFKN 125-12-88 N4A	125	38.1	15.9	63	12	
SFKN 125-12-88 N4	125	40	16.4	63	12	

SNCN .. ZZT

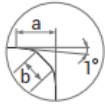
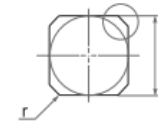
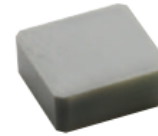

Type		Dimensions (mm)			
ISO	ASA	d	t	a	b
SNCN 0904 ZZT	SNCN 33 ZZT	9.52	4.76	1.30	1.10
SNCN 1204 ZZT	SNCN 43 ZZT	12.70	4.76	3.25	1.10

SNCN .. ZN

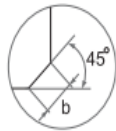

Type		Dimensions (mm)		
ISO	ASA	d	t	b
SNCN 1204 ZN	SNCN 43 ZN	12.70	4.76	1.10

Dimensions (mm) D	Spare parts		
	Wedge	Wedge Screw	Wrench
40 - 50			
63 - 125			
	SSW9	WS6 (M6)	LW3
	SSW10	WS6 (M6)	LW3

For Gray Cast Iron

Process	Hardness (HB)	Cutting Speed Vc(m/min)	Feed fz(mm/z)	Depth ap(mm)	Surface Quality Ra(μm)
Roughing	190~210	800~2,000	0.08~0.15	2.0~5.0	6.3~12.5
Roughing	220~240	500~1,500	0.08~0.15	2.0~5.0	6.3~12.5
Roughing	250~280	300~1,200	0.08~0.15	2.0~5.0	6.3~12.5

SFKN .. 75



Axial rake angle : -6°

Radial rake angle : -10°

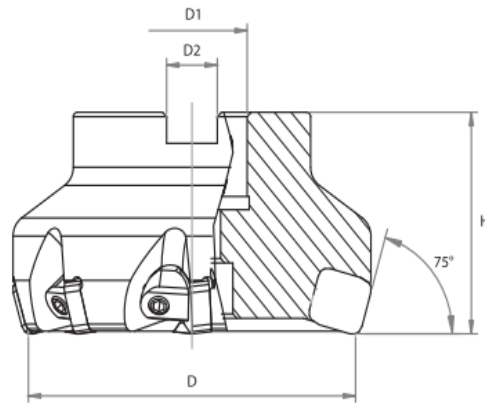

Type	Dimensions (mm)				⚙️	Insert
	D	D ₁	D ₂	H		
SFKN 050-05-75 N4	50	22	10.4	40	5	SNCN 1204 ENTN SNGN 1204 □□
SFKN 063-06-75 N4	63	22	10.4	40	6	
SFKN 080-08-75 N4A	80	25.4	9.5	50	8	
SFKN 080-08-75 N4	80	27	12.4	50	8	
SFKN 100-10-75 N4A	100	31.75	12.7	50	10	
SFKN 100-10-75 N4	100	32	14.4	50	10	
SFKN 125-12-75 N4A	125	38.1	15.9	63	12	
SFKN 125-12-75 N4	125	40	16.4	63	12	

SNCN .. ENTN

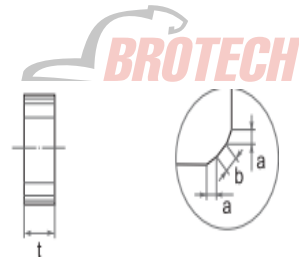
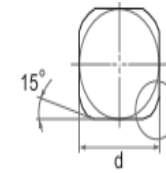

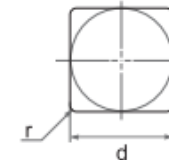

Type		Dimensions (mm)			
ISO	ASA	d	t	a	b
SNCN 1204 ENTN	SNCN 43 ENTN	12.70	4.76	1.40	1.00

SNGN



Type		Dimensions (mm)		
ISO	ASA	d	t	r
SNGN 120412	SNGN 433	12.70	4.76	1.2
SNGN 120416	SNGN 434	12.70	4.76	1.6

Dimensions (mm) D	Spare parts		
	Wedge	Wedge Screw	Wrench
50			
63 - 125	SSW10	WS6 (M6)	LW3

For Gray Cast Iron

Process	Hardness (HB)	Cutting Speed Vc(m/min)	Feed fz(mm/z)	Depth ap(mm)	Surface Quality Ra(μm)
Roughing	190~210	800~2,000	0.10~0.20	2.0~5.0	6.3~12.5
Roughing	220~240	500~1,500	0.10~0.20	2.0~5.0	6.3~12.5
Roughing	250~280	300~1,200	0.10~0.20	2.0~5.0	6.3~12.5

SFKN .. 45



Axial rake angle : -6°

Radial rake angle : -12°

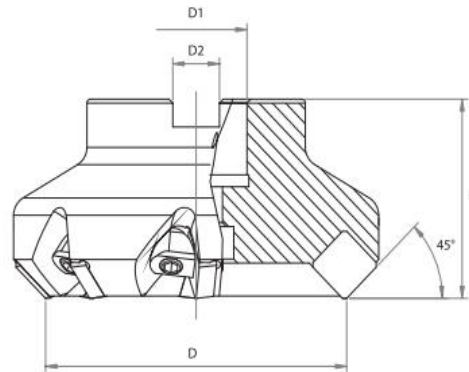

SNCN

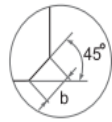

Type		Dimensions (mm)		
ISO	ASA	d	t	b
SNCN 1204 AN	SNCN 43 AN	12.70	4.76	2.50
SNCN 1204 ZN	SNCN 43 ZN	12.70	4.76	1.10

SNGN

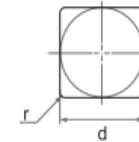

Type		Dimensions (mm)		
ISO	ASA	d	t	r
SNGN 120412	SNGN 433	12.70	4.76	1.2
SNGN 120416	SNGN 434	12.70	4.76	1.6

Type	Dimensions (mm)				⚙️	Insert
	D	D ₁	D ₂	H		
SFKN 050-05-45 N4	50	22	10.4	40	5	SNCN 1204 AN SNCN 1204 ZN SNGN 1204 □□
SFKN 063-06-45 N4	63	22	10.4	40	6	
SFKN 080-08-45 N4A	80	25.4	9.5	50	8	
SFKN 080-08-45 N4	80	27	12.4	50	8	
SFKN 100-10-45 N4A	100	31.75	12.7	50	10	
SFKN 100-10-45 N4	100	32	14.4	50	10	
SFKN 125-12-45 N4A	125	38.1	15.9	63	12	
SFKN 125-12-45 N4	125	40	16.4	63	12	

Dimensions (mm) D	Spare parts		
	Wedge	Wedge Screw	Wrench
50			
63 - 125			

For Gray Cast Iron

Process	Hardness (HB)	Cutting Speed Vc(m/min)	Feed fz(mm/z)	Depth ap(mm)	Surface Quality Ra(μm)
Roughing	190 ~210	800 ~2,000	0.15 ~0.30	2.0~5.0	3.2~12.5
Roughing	220 ~240	500 ~1,500	0.15 ~0.30	2.0~5.0	3.2~12.5
Roughing	250 ~280	300 ~1,200	0.15 ~0.30	2.0~5.0	3.2~12.5

SFKP .. 88



Axial rake angle : +7°

Radial rake angle : +3°

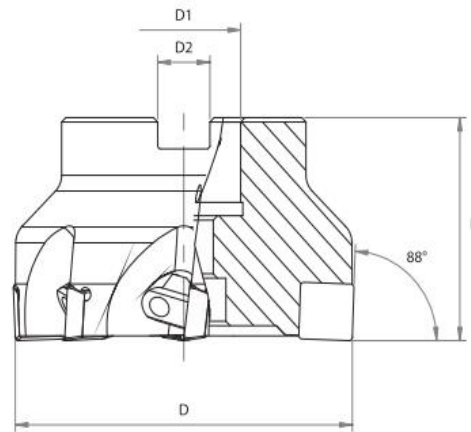

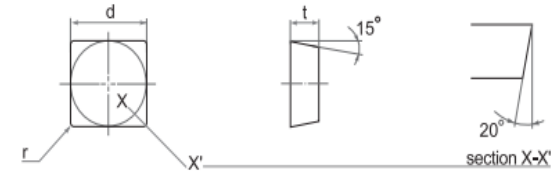

SDCN .. T

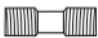

Type		Dimensions (mm)		
ISO	ASA	d	t	r
SDCN 120408 T20	SDCN 432 T20	12.70	4.76	0.8
SDCN 120412 T20	SDCN 433 T20	12.70	4.76	1.2

Type	Dimensions (mm)				⚙️	Insert
	D	D ₁	D ₂	H		
SFKP 050-05-88 N4	50	22	10.4	40	5	SDCN 1204 □□ T20
SFKP 063-06-88 N4	63	22	10.4	40	6	
SFKP 080-08-88 N4A	80	25.4	9.5	50	8	
SFKP 080-08-88 N4	80	27	12.4	50	8	
SFKP 100-10-88 N4A	100	31.75	12.7	50	10	
SFKP 100-10-88 N4	100	32	14.4	50	10	
SFKP 125-12-88 N4A	125	38.1	15.9	63	12	
SFKP 125-12-88 N4	125	40	16.4	63	12	

Dimensions (mm) D	Spare parts		
	Wedge	Wedge Screw	Wrench
50			
63 - 125	SSW9	WS6 (M6)	LW3
	SSW10	WS6 (M6)	LW3

For Gray Cast Iron

Process	Hardness (HB)	Cutting Speed Vc(m/min)	Feed fz(mm/z)	Depth ap(mm)	Surface Quality Ra(μm)
Roughing	190~210	800~2,000	0.08~0.15	2.0~5.0	6.3~12.5
Roughing	220~240	500~1,500	0.08~0.15	2.0~5.0	6.3~12.5
Roughing	250~280	300~1,200	0.08~0.15	2.0~5.0	6.3~12.5

SFKP .. 75



Axial rake angle : +5°

Radial rake angle : 0°

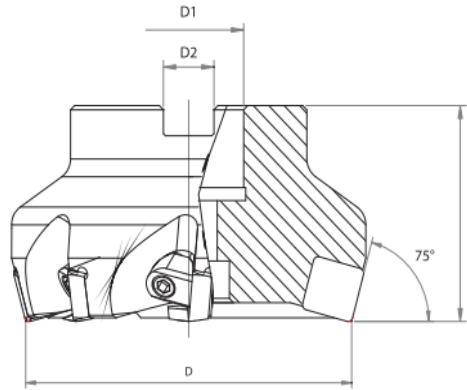

Type	Dimensions (mm)				⚙️	Insert
	D	D ₁	D ₂	H		
SFKP 050-05-75 N4	50	22	10.4	40	5	SPCN 1204 □ T15 SPKN 1204SP EDTR
SFKP 063-06-75 N4	63	22	10.4	40	6	
SFKP 080-08-75 N4A	80	25.4	9.5	50	8	
SFKP 080-08-75 N4	80	27	12.4	50	8	
SFKP 100-10-75 N4A	100	31.75	12.7	50	10	
SFKP 100-10-75 N4	100	32	14.4	50	10	
SFKP 125-12-75 N4A	125	38.1	15.9	63	12	
SFKP 125-12-75 N4	125	40	16.4	63	12	

SPCN .. T

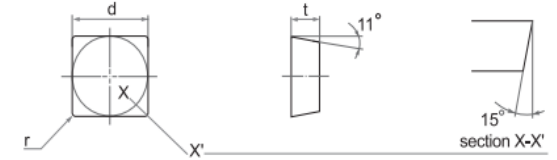
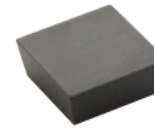

Type		Dimensions (mm)		
ISO	ASA	d	t	r
SPCN 120412 T15	SPCN 433 T15	12.70	4.76	1.2
SPCN 120416 T15	SPCN 434 T15	12.70	4.76	1.6

SPKN .. SP

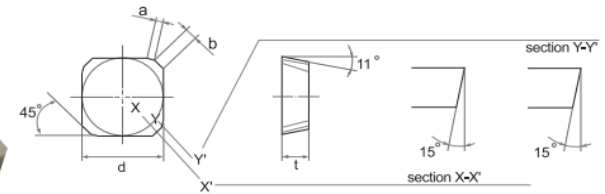

Type		Dimensions (mm)			
ISO	ASA	d	t	a	b
SPKN 1204SP EDTR	SPKN 433SP EDTR	12.70	4.76	1.10	1.30

Dimensions (mm) D	Spare parts		
	Wedge	Wedge Screw	Wrench
50			
63 - 125			

For Gray Cast Iron

Process	Hardness (HB)	Cutting Speed Vc(m/min)	Feed fz(mm/z)	Depth ap(mm)	Surface Quality Ra(μm)
Roughing	190~210	800~2,000	0.10~0.20	2.0~5.0	3.2~12.5
Roughing	220~240	500~1,500	0.10~0.20	2.0~5.0	3.2~12.5
Roughing	250~280	300~1,200	0.10~0.20	2.0~5.0	3.2~12.5

SFKP .. 45



Axial rake angle : +19°

Radial rake angle : -6°

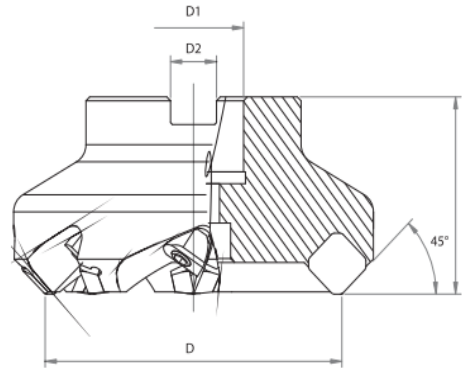

Type	Dimensions (mm)				⚙️	Insert
	D	D ₁	D ₂	H		
SFKP 050-05-45 N4	50	22	10.4	40	5	SEAN 1204 AFTN W25 SEAN 1204 □T25
SFKP 063-06-45 N4	63	22	10.4	40	6	
SFKP 080-08-45 N4A	80	25.4	9.5	50	8	
SFKP 080-08-45 N4	80	27	12.4	50	8	
SFKP 100-10-45 N4A	100	31.75	12.7	50	10	
SFKP 100-10-45 N4	100	32	14.4	50	10	SEAN 1203 NWAFTN SEAN 1203 AFTN
SFKP 050-05-45 N3	50	22	10.4	40	5	
SFKP 063-06-45 N3	63	22	10.4	40	6	
SFKP 080-08-45 N3A	80	25.4	9.5	50	8	
SFKP 080-08-45 N3	80	27	12.4	50	8	
SFKP 100-10-45 N3A	100	31.75	12.7	50	10	SEAN 1203 NWAFTN SEAN 1203 AFTN
SFKP 100-10-45 N3	100	32	14.4	50	10	

Dimensions (mm) D	Spare parts		
	Wedge	Wedge Screw	Wrench
50			
63 - 125	SSW9	WS6 (M6)	LW3
	SSW10	WS6 (M6)	LW3

For Gray Cast Iron

Process	Hardness (HB)	Cutting Speed Vc(m/min)	Feed fz(mm/z)	Depth ap(mm)	Surface Quality Ra(μm)
Roughing	190~210	800~2,000	0.15~0.30	2.0~5.0	6.3~12.5
Roughing	220~240	500~1,500	0.15~0.30	2.0~5.0	6.3~12.5
Roughing	250~280	300~1,200	0.15~0.30	2.0~5.0	6.3~12.5

SEAN

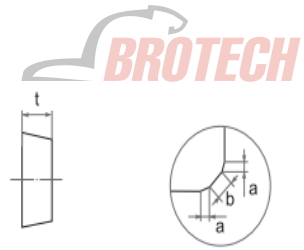
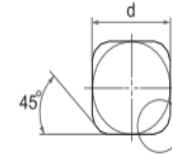

Type		Dimensions (mm)			
ISO	ASA	d	t	a	b
SEAN 1203 AFTN	SEAN 42 AFTN	12.70	3.18	0.50	1.80

SEAN .. NW

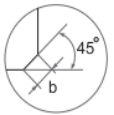
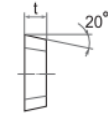
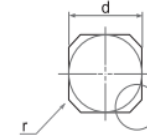

Type		Dimensions (mm)			
ISO	ASA	d	t	b	r
SEAN 1203 NWAFTN	SEAN 42 NWAFTN	12.70	3.18	2.40	0.4
SEAN 1204 AFTNW25	SEAN 43 AFTNW25	12.70	4.76	2.50	1.2

SEAN .. T

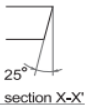
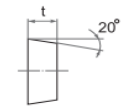
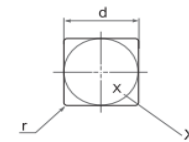

Type		Dimensions (mm)		
ISO	ASA	d	t	a
SEAN 120412 T25	SEAN 433 T25	12.70	4.76	1.2
SEAN 120416 T25	SEAN 434 T25	12.70	4.76	1.6

SFAN .. 88



Axial rake angle : -7°

Radial rake angle : -10°

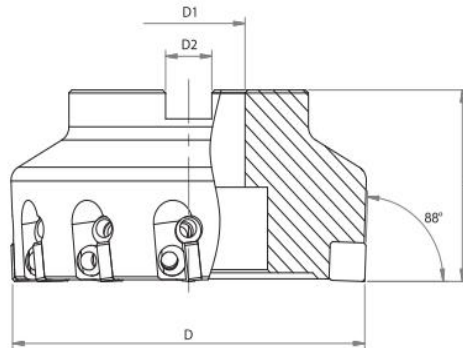

SNCN .. ZZT

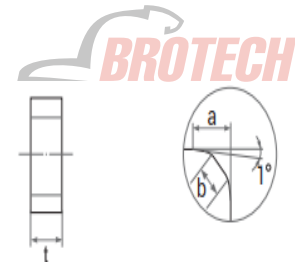



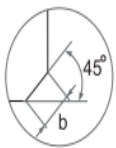

Type		Dimensions (mm)			
ISO	ASA	d	t	a	b
SNCN 1204 ZZT	SNCN 43 ZZT	12.70	4.76	3.25	1.10

Type	Dimensions (mm)				⚙️	Insert
	D	D ₁	D ₂	H		
SFAN 063-06-88 N4	63	22	10.4	40	6	SNCN 1204 ZZT SNCN 1204 ZN
SFAN 080-08-88 N4A	80	25.4	9.5	50	8	
SFAN 080-08-88 N4	80	27	12.4	50	8	
SFAN 100-10-88 N4A	100	31.75	12.7	50	10	
SFAN 100-10-88 N4	100	32	14.4	50	10	
SFAN 125-12-88 N4A	125	38.1	15.9	63	12	
SFAN 125-12-88 N4	125	40	16.4	63	12	

SNCN .. ZN



Type		Dimensions (mm)		
ISO	ASA	d	t	b
SNCN 1204 ZN	SNCN 43 ZN	12.70	4.76	1.10

Dimensions (mm)	Spare parts				
	Wedge	Wedge Screw	Adjust Wedge	Adjust Wedge Screw	Wrench
63 - 125					
	SW16	WS6 (M6)	SAW 20	WS6 (M6)	LW3

For Gray Cast Iron

Process	Hardness (HB)	Cutting Speed Vc(m/min)	Feed fz(mm/z)	Depth ap(mm)	Surface Quality Ra(μm)
Roughing	190~210	800~2,000	0.08~0.15	2.0~5.0	6.3~12.5
Roughing	220~240	500~1,500	0.08~0.15	2.0~5.0	6.3~12.5
Roughing	250~280	300~1,200	0.08~0.15	2.0~5.0	6.3~12.5
Finishing	190~210	200~900	0.05~0.10	0.1~0.5	0.8

SFAN .. 75



Axial rake angle : -6°

Radial rake angle : -10°

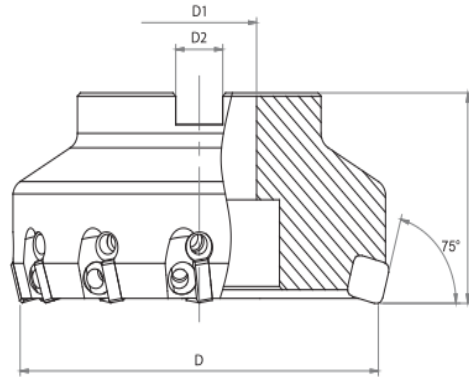

Type	Dimensions (mm)				⚙️	Insert
	D	D ₁	D ₂	H		
SFAN 063-06-75 N4	63	22	10.4	40	6	SNCN 1204 ENTN SNGN 1204 □□
SFAN 080-08-75 N4A	80	25.4	9.5	50	8	
SFAN 080-08-75 N4	80	27	12.4	50	8	
SFAN 100-10-75 N4A	100	31.75	12.7	50	10	
SFAN 100-10-75 N4	100	32	14.4	50	10	
SFAN 125-12-75 N4A	125	38.1	15.9	63	12	
SFAN 125-12-75 N4	125	40	16.4	63	12	

SNCN .. ENTN

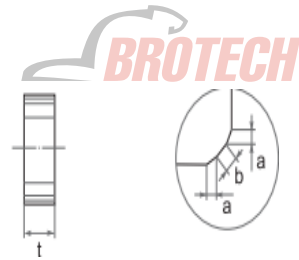
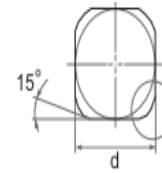



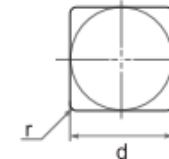

Type		Dimensions (mm)			
ISO	ASA	d	t	a	b
SNCN 1204 ENTN	SNCN 43 ENTN	12.70	4.76	1.40	1.00

SNGN



Type		Dimensions (mm)		
ISO	ASA	d	t	r
SNGN 120412	SNGN 433	12.70	4.76	1.2
SNGN 120416	SNGN 434	12.70	4.76	1.6

Dimensions (mm)	Spare parts				
	Wedge	Wedge Screw	Adjust Wedge	Adjust Wedge Screw	Wrench
63 - 125					
	SW16	WS6 (M6)	SAW 20	WS6 (M6)	LW3

For Gray Cast Iron

Process	Hardness (HB)	Cutting Speed Vc(m/min)	Feed fz(mm/z)	Depth ap(mm)	Surface Quality Ra(μm)
Roughing	190~210	800~2,000	0.08~0.15	2.0~5.0	6.3~12.5
Roughing	220~240	500~1,500	0.08~0.15	2.0~5.0	6.3~12.5
Roughing	250~280	300~1,200	0.08~0.15	2.0~5.0	6.3~12.5
Finishing	190~210	200~900	0.08~0.15	0.1~0.5	0.8
Finishing	220~240	200~700	0.08~0.15	0.1~0.5	0.8
Finishing	250~280	200~500	0.08~0.15	0.1~0.5	0.8

SFSP .. OT



Axial rake angle : +3°

Radial rake angle : +7°

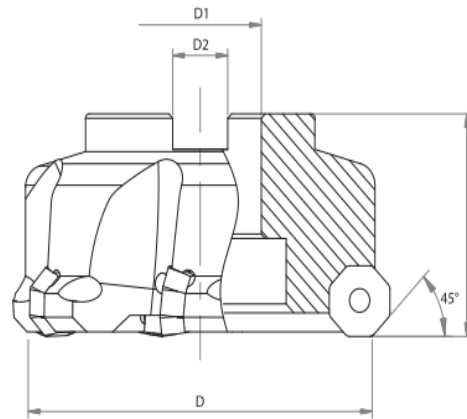

Type	Dimensions (mm)				⚙️	Insert
	D	D ₁	D ₂	H		
SFSP 063-05-45-A4 OT	63	22	10.40	40	5	OEGB 0704 □□
SFSP 080-06-45-A4 OT	80	27	12.40	50	6	
SFSP 100-07-45-A4 OT	100	32	14.40	50	7	

OEGB

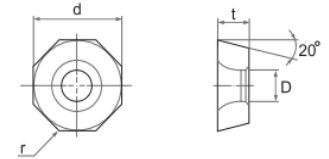

Type	Dimensions (mm)			
ISO	d	t	D	r
OEGB 070408	15.87	4.76	5.18	0.8
OEGB 070416	15.87	4.76	5.18	1.6

Dimensions (mm)	Spare parts	
	Screw	Wrench
63 - 100	SWS 21480072	T20

SFKN .. HX



D : 80~200

Axial rake angle : -6°

Radial rake angle : -7°



D : 250~315

HNEN

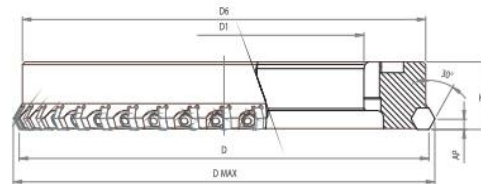
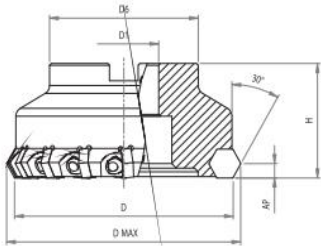
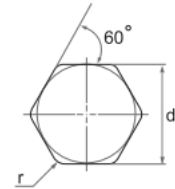

Type	Dimensions (mm)		
ISO	d	t	r
HNEN 090520	16.20	5.56	2.0
HNEN 090530	16.20	5.56	3.0
HNEN 090508 ANSN	15.87	5.64	0.8

Type	Dimensions (mm)					AP max	Insert
	D	D(max)	D ₁	D _c	H		
SFKN 080-08-30 N5HXA	80	88.7	25.4	52	50	8	HNEN 090520 HNEN 090530 HNEN 090508 ANSN
SFKN 080-08-30 N5HX	80	88.7	27	58	50	8	
SFKN 100-10-30 N5HXA	100	108.7	31.75	60	50	10	
SFKN 100-10-30 N5HX	100	108.7	32	60	50	10	
SFKN 125-16-30 N5HXA	125	133.7	38.1	80	63	16	
SFKN 125-16-30 N5HX	125	133.7	40	85	63	16	
SFKN 160-20-30 N5HXA	160	168.7	50.8	99	63	20	
SFKN 160-20-30 N5HX	160	168.7	40	85	63	20	
SFKN 200-26-30 N5HXA	200	208.7	47.625	128.57	63	26	
SFKN 200-26-30 N5HX	200	208.7	60	140	63	26	
SFKN 250-30-30 N5HXA	250	258.7	160.02	-	50	30	
SFKN 315-40-30 N5HXA	315	323.7	215.02	-	50	40	

Dimensions (mm)	Spare parts		
	Wedge	Wedge Screw	Wrench
80 - 315	DT-SW16	WS6	LW3

SFCN .. 00 .. R

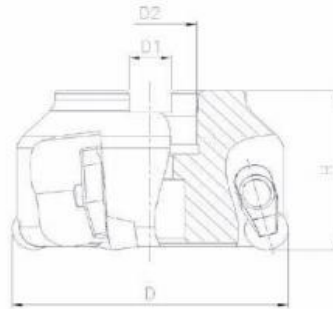

Type	Dimensions (mm)				⚙️	Insert	
	D	D ₁	D ₂	H			
SFCN 050-04-00 R4	50	10.4	22	50	4	RNGN 120400	
SFCN 050-04-00 R4A	50.8	7.9	19.05	50	4		
SFCN 063-04-00 R4	63	10.4	22	50	4		
SFCN 063-04-00 R4A	63.5	7.9	19.05	50	4		
SFCN 080-05-00 R4	80	12.4	27	50	5		
SFCN 080-05-00 R4A	76.2	9.5	25.4	50	5		
SFCN 100-06-00 R4	100	14.4	32	50	6		
SFCN 100-06-00 R4A	101.6	12.7	31.75	50	6		
SFCN 050-04-00 R7	50	10.4	22	50	4		RNGN 120700
SFCN 050-04-00 R7A	50.8	7.9	19.05	50	4		
SFCN 063-04-00 R7	63	10.4	22	50	4		
SFCN 063-04-00 R7A	63.5	7.9	19.05	50	4		
SFCN 080-05-00 R7	80	12.4	27	50	5		
SFCN 080-05-00 R7A	76.2	9.5	25.4	50	5		
SFCN 100-06-00 R7	100	14.4	32	50	6		
SFCN 100-06-00 R7A	101.6	12.7	31.75	50	6		



RNGN

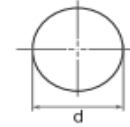
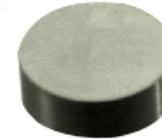

Type		Dimensions (mm)	
ISO	ASA	d	t
RNGN 120400	RNGN 43	12.7	4.76
RNGN 120700	RNGN 45	12.7	7.94

Dimensions (mm)	Spare parts			
	Clamp	Clamp Screw	Spring	Wrench
50 - 100	AMS6T	A0B-6S	SP5	LW3

SFCP .. 00 .. R

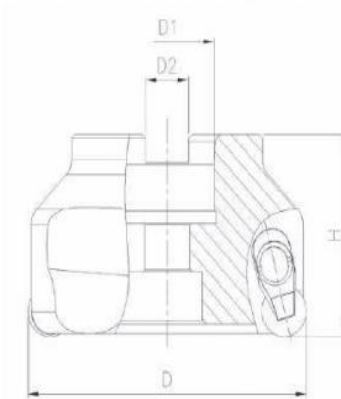





Type	Dimensions (mm)				⚙️	Insert
	D	D ₁	D ₂	H		
SFCP 050-04-00 R4	50	10.4	22	50	4	RPGN 120400
SFCP 050-04-00 R4A	50.8	7.9	19.05	50	4	
SFCP 063-04-00 R4	63	10.4	22	50	4	
SFCP 063-04-00 R4A	63.5	7.9	19.05	50	4	
SFCP 080-05-00 R4	80	12.4	27	50	5	
SFCP 080-05-00 R4A	76.2	9.5	25.4	50	5	
SFCP 100-06-00 R4	100	14.4	32	50	6	
SFCP 100-06-00 R4A	101.6	12.7	31.75	50	6	

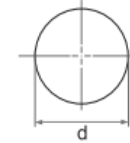
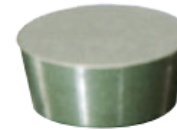

RPGN

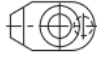

Type		Dimensions (mm)	
ISO	ASA	d	t
RPGN120400	RPGN 43	12.7	4.76

Dimensions (mm)	Spare parts			
	Clamp	Clamp Screw	Spring	Wrench
				
50 - 100	AMS6T	A0B-6S	SP5	LW3

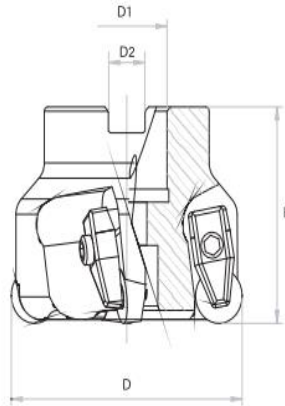

RNGX .. DP

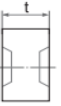
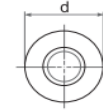

Type		Dimensions (mm)	
ISO	ASA	d	t
RNGX 1207 DP	RNGX 45 DP	12.70	7.94

Type	Dimensions (mm)				⚙️	Insert
	D	D ₁	D ₂	H		
SFXN 050-03-00 RX7A	50	19.05	7.9	50	3	RNGX 1207 DP
SFXN 050-03-00 RX7	50	22	10.4	50	3	
SFXN 063-04-00 RX7A	63	19.05	12.7	50	4	
SFXN 063-04-00 RX7	63	22	10.4	50	4	
SFXN 080-05-00 RX7A	80	25.4	9.5	50	5	
SFXN 080-05-00 RX7	80	27	12.4	50	5	
SFXN 100-06-00 RX7A	100	31.75	12.7	50	6	
SFXN 100-06-00 RX7	100	32	14.4	50	6	

Dimensions (mm)	Spare parts			
	Clamp	Screw	Spring	Wrench
50 - 100	SCL 5M	SLS4	SP4	LW3

Recommended Cutting Conditions

Work - Piece	Hardness (HB)	Cutting Speed Vc(m/min)	Feed fz(mm/z)	Depth ap(mm) max
Iron-base, Heat-resistant alloys	135~328	300~900	0.05~0.13	6.35
Cobalt-base, Heat-resistant alloys	150~425	270~1,200	0.05~0.13	6.35
Nickel base, Heat-resistant alloys	140~475	270~1,200	0.05~0.13	6.35
PH Stainless steels	135~450	520~700	0.08~0.10	6.35

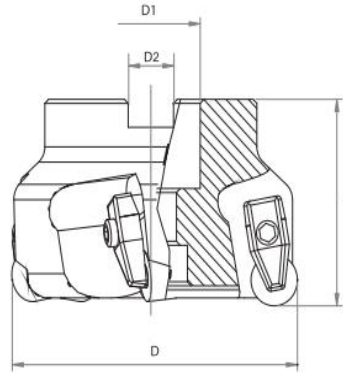

RPGX .. DP

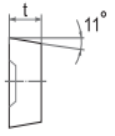

Type		Dimensions (mm)	
ISO	ASA	d	t
RPGX 1204 DP	RPGX 43 DP	12.70	4.76

Type	Dimensions (mm)				Z	Insert
	D	D ₁	D ₂	H		
SFXP 050-03-00 RP4A	50	19.05	7.9	50	3	RPGX 1204 DP
SFXP 050-03-00 RP4	50	22	10.4	50	3	
SFXP 050-04-00 RP4A	50	19.05	7.9	50	4	
SFXP 050-04-00 RP4	50	22	10.4	50	4	
SFXP 063-04-00 RP4A	63	19.05	7.9	63	4	
SFXP 063-04-00 RP4	63	22	10.4	63	4	
SFXP 080-05-00 RP4A	80	25.4	9.5	50	5	
SFXP 080-05-00 RP4	80	27	12.4	50	5	
SFXP 100-06-00 RP4A	100	31.75	12.7	50	6	
SFXP 100-06-00 RP4	100	32	14.4	50	6	

Dimensions (mm)	Spare parts			
	Clamp	Screw	Spring	Wrench
D				
50 - 100	SCL 5M	SLS4	SP4	LW3

Recommended Cutting Conditions

Work - Piece	Hardness (HB)	Cutting Speed Vc(m/min)	Feed fz(mm/z)	Depth ap(mm) max
Iron-base, Heat-resistant alloys	135~328	300~900	0.05~0.13	6.35
Cobalt-base, Heat-resistant alloys	150~425	270~1,200	0.05~0.13	6.35
Nickel base, Heat-resistant alloys	140~475	270~1,200	0.05~0.13	6.35
PH Stainless steels	135~450	520~700	0.08~0.10	6.35

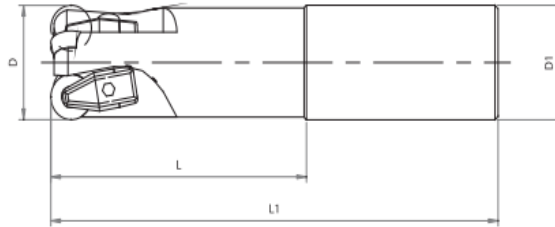

RPGX .. DP

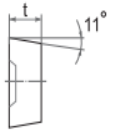

Type		Dimensions (mm)	
ISO	ASA	d	t
RPGX 1204 DP	RPGX 43 DP	12.70	4.76

Type	Dimensions (mm)				⚙️	Insert
	D	D ₁	L	L ₁		
SEXP 032-02-80140 X4	32	32	80	140	2	RPGX 1204 DP
SEXP 032-03-40100 X4A	32	31.75	40	100	3	
SEXP 032-03-40100 X4	32	32	40	100	3	
SEXP 032-03-80140 X4A	32	31.75	80	140	3	
SEXP 032-03-80140 X4	32	32	80	140	3	
SEXP 038-03-50100 X4A	38	38.1	50	100	3	
SEXP 038-03-50100 X4	38	32	50	100	3	
SEXP 038-03-90140 X4A	38	38.1	90	140	3	
SEXP 038-03-90140 X4	38	32	90	140	3	

Dimensions (mm)	Spare parts			
	Clamp	Screw	Spring	Wrench
32 - 38	SCL 5M	SLS4	SP4	LW3

Recommended Cutting Conditions

Work - Piece	Hardness (HB)	Cutting Speed V _c (m/min)	Feed f _z (mm/z)	Depth a _p (mm) max
Iron-base, Heat-resistant alloys	135~328	300~900	0.05~0.13	6.35
Cobalt-base, Heat-resistant alloys	150~425	270~1,200	0.05~0.13	6.35
Nickel base, Heat-resistant alloys	140~475	270~1,200	0.05~0.13	6.35
PH Stainless steels	135~450	520~700	0.08~0.10	6.35

04. ARBOR

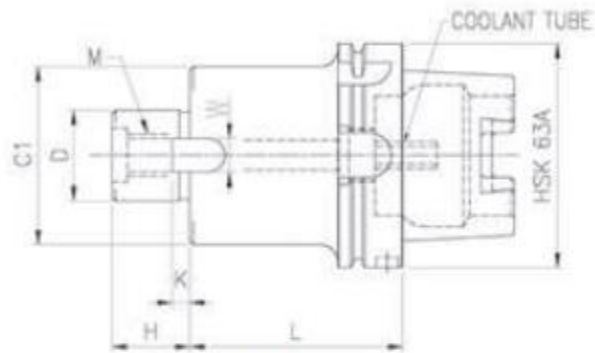

Model A

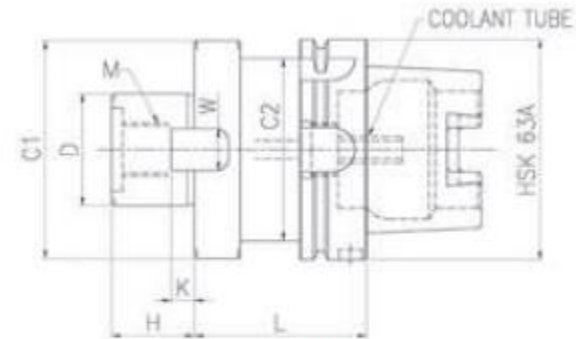

Model B

Type	Dimensions (mm)							M	Weight (kg)	Model	Cutter
	D	L	H	C ₁	C ₂	W	K				
HSK 63A-FMA22-50	22	50	19	50	50	9.5	5	M10	1.2	A	HPA 025R
HSK 63A-FMA25.4-60	25.4	60	22	50	50	9.5	5	M12	1.3	A	HPA 03R
HSK 63A-FMA25.4-90	25.4	90	22	50	50	9.5	5	M12	1.9	A	HPA 03R
HSK 63A-FMA25.4-120	25.4	120	22	50	50	9.5	5	M12	2.3	A	HPA 03R
HSK 63A-FMA31.75-60	31.75	60	30	60	53	12.7	7	M16	1.7	B	HPA 04R
HSK 63A-FMA31.75-90	31.75	90	30	60	53	12.7	7	M16	2.5	B	HPA 04R
HSK 63A-FMA31.75-120	31.75	120	30	60	53	12.7	7	M16	3.3	B	HPA 04R
HSK 63A-FMA38.1-60	38.1	60	34	80	53	15.9	9	M20	2.1	B	HPA 05R
HSK 63A-FMA38.1-90	38.1	90	34	80	53	15.9	9	M20	3	B	HPA 05R
HSK 63A-FMA38.1-120	38.1	120	34	80	53	15.9	9	M20	4.4	B	HPA 05R

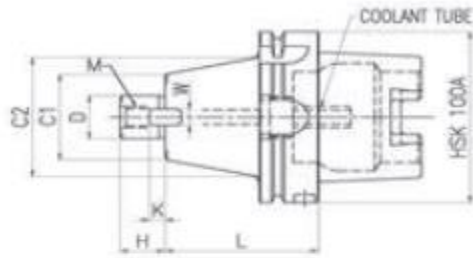

Model A

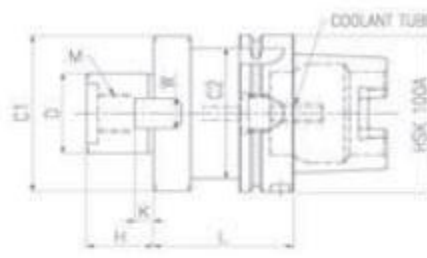

Model B

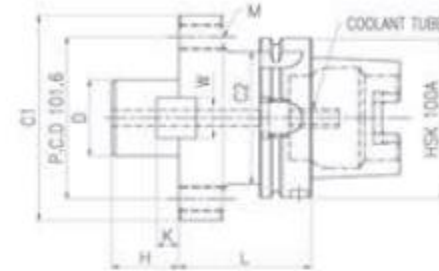

Model C

Type	Dimensions (mm)							M	Weight (kg)	Model	Cutter
	D	L	H	C ₁	C ₂	W	K				
HSK 100A-FMA25.4-75	25.4	75	22	50	70	9.5	5	M12	3.2	A	HPA 03R
HSK 100A-FMA25.4-105	25.4	105	22	50	70	9.5	5	M12	3.9	A	HPA 03R
HSK 100A-FMA25.4-135	25.4	135	22	50	70	9.5	5	M12	4.6	A	HPA 03R
HSK 100A-FMA31.75-75	31.75	75	30	60	70	12.7	7	M16	3.5	A	HPA 04R
HSK 100A-FMA31.75-105	31.75	105	30	60	70	12.7	7	M16	4.3	A	HPA 04R
HSK 100A-FMA31.75-135	31.75	135	30	60	70	12.7	7	M16	5.1	A	HPA 04R
HSK 100A-FMA38.1-75	38.1	75	34	80	80	15.9	9	M20	4.4	A	HPA 05R
HSK 100A-FMA38.1-105	38.1	105	34	80	80	15.9	9	M20	5.7	A	HPA 05R
HSK 100A-FMA38.1-135	38.1	135	34	80	80	15.9	9	M20	7.0	A	HPA 05R
HSK 100A-FMA50.8-75	50.8	75	36	99	83	19.05	10	M24	5.7	B	HPA 06R
HSK 100A-FMA50.8-105	50.8	105	36	99	83	19.05	10	M24	7.7	B	HPA 06R
HSK 100A-FMA50.8-135	50.8	135	36	99	83	19.05	10	M24	9.7	B	HPA 06R
HSK 100A-FMA47.625-75	47.625	75	38	128.57	83	25.4	12.5	M16		C	HPA 08R

KORLOY Global Network



We stand to be the Global Top Manufacturer. Korea's Best. World's Best

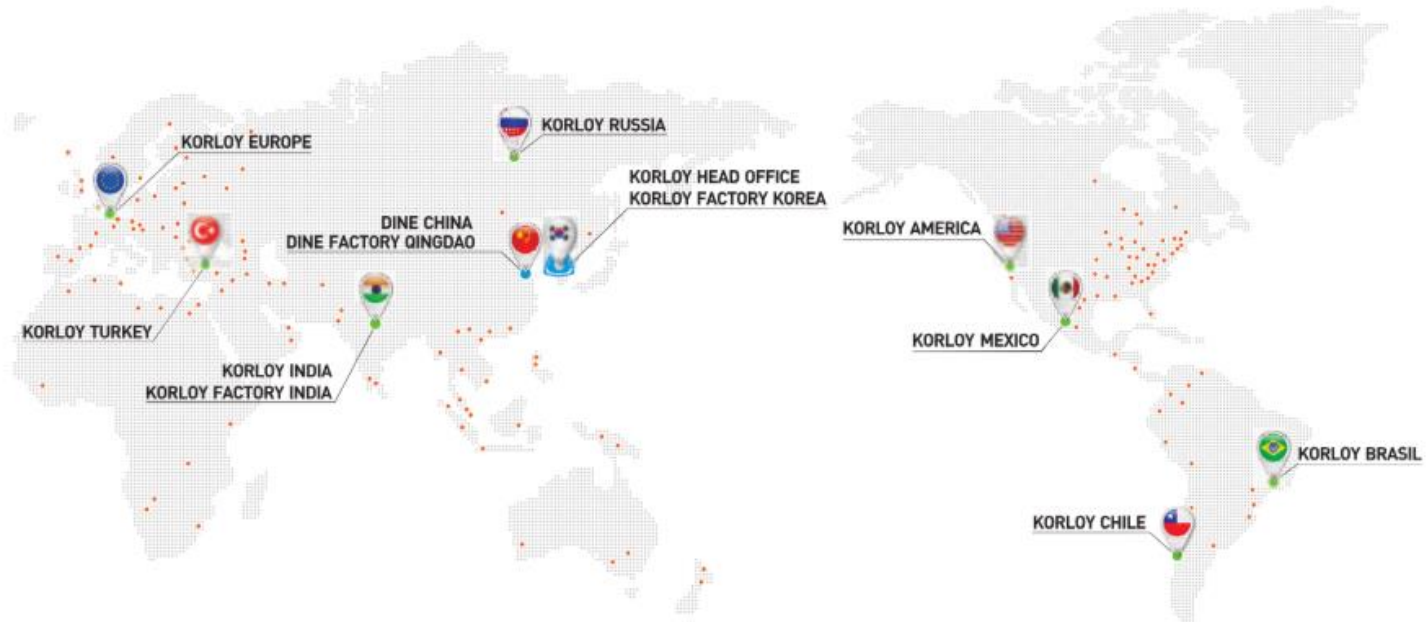

Head Office

Holystar B/D, 326, Seocho-daero, Seocho-gu,
Seoul, 06633, Republic of Korea

Tel: +82-2-522-3181 Fax: +82-2-522-3184, +82-2-3474-4744

R&D Institute Cheongju

55, Sandan-ro, Heungdeok-gu, Cheongju-si,
Chungcheongbuk-do, 28589, Korea

Tel: +82-43-262-0141 Fax: +82-43-262-0711

Cheongju Factory

55, Sandan-ro, Heungdeok-gu, Cheongju-si,
Chungcheongbuk-do, 28589, Korea

Tel: +82-43-262-0141 Fax: +82-43-263-8731

Jincheon Factory

54, Gwanghyewonsandan 2-gil, Gwanghyewon-myeon,
Jincheon-gun, Chungcheongbuk-do, 27807, Korea

Tel: +82-43-535-0141 Fax: +82-43-535-0144